



Flex • AC • MC ([View All](#) 4.6MB PDF)

[Previous Item](#) [Next Item](#)

SNAP²IT® Duplex Connectors with Insulated Throat

New!

Zinc die-cast. For MC/HCF steel and aluminum cable • AC/HCF steel and aluminum cable • Flexible metal conduit steel and aluminum (regular and reduced wall) • MC cable continuous corrugated aluminum • MCI-A cable.



383810AST



404010AST

CATALOG NUMBER	UPC/DCI/NAED MFG #01 8997	TRADE SIZE	KO SIZE	UNIT PKG	STD PKG	DIM A	DIM B	DIM C	DIM D	CABLE RANGE
383810AST	10937	3/8	1/2	25	100	2.398	2.035	.840	.624	(2).370-.490
404010AST†	40533	3/8	1/2	25	100	2.398	2.165	.840	.624	(2).405-.612
505010AST	50720	1/2	3/4	25	25	3.054	2.717	1.058	.810	(2).590-.920

†Provided with red tinted inside clips so you can differentiate a 383810AST from a 404010AST.

Refer to chart on page E-26 for a list of cable types.

Refer to chart on page E-27 for MCI-A cable ranges.

Concrete tight when taped.

SNAP-TITE® and SNAP²IT® products have been tested and listed by UL in accordance with UL's ground fault requirements.

For additional information see page 6.

PATENT PENDING.

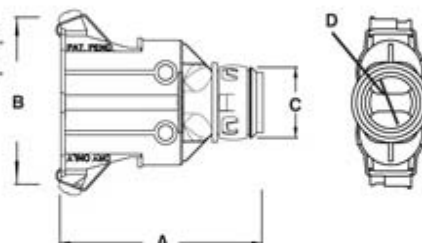

372D LR49636

Secure hold – Easy cable insertion!
Simply snap the cable into the fitting and snap it into the box...no tools needed!
The screw only holds the clip in place.

FOR THE WIDEST TOTAL CABLE RANGES

See Also:

- [Chart of MCI-A Cable Ranges](#)
- [Chart of Cable Types \(page 3\)](#)
- [SNAP-TITE® & SNAP²IT® Products Note](#)

[Home](#) | [Contents](#) | [Product Index](#) | [What's New](#)
[Samples](#) | [Local Reps](#) | [Contact Us](#)

Copyright © 2008. Arlington Industries. All rights reserved.