

HARDWARE FITTINGS FORGED STEEL BALL CLEVIS

Ball clevises are used to attach ball and socket insulators to other associated tower hardware.

Material: Body—galvanized steel
Clevis Pin—galvanized steel
Cotter Pin—stainless steel

FORGED STEEL
BC

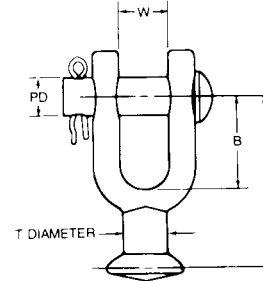

CATALOG NUMBER	ULTIMATE STRENGTH LBS. (KG)	DIMENSIONS INCHES (MM)					APPROX. WT. EACH LBS. (KG)
		L	B	W	PD	T DIA.	
BC-30	30,000 (13,608)	2-7/8 (73.03)	1-9/16 (39.69)	15/16 (23.81)	5/8 (15.88)	23/32 (18.26)	.95 (.43)
*BC-50	50,000 (22,680)	4-5/16 (109.54)	1-15/16 (49.21)	15/16 (23.81)	7/8 (22.23)	57/64 (22.62)	2.3 (1.04)
70488-2000	30,000 (13,608)	3-15/16 (100.01)	2-1/2 (63.50)	13/16 (20.64)	5/8 (15.88)	23/32 (18.26)	1.24 (.56)

NOTE: For use with class 52-3 and 52-5 insulators per ANSI Spec. C-29.2-71.
*For use with class 52-8 and 52-11 insulators per ANSI Spec. C-29.2-71.

HARDWARE FITTINGS FORGED STEEL BALL Y-CLEVIS

Ball Y-clevises are used to attach ball and socket insulators to other associated hardware. The bent bolt in the Y-clevis section provides an additional point of articulation.

Material: Body—galvanized steel
Clevis Pin—galvanized steel
Cotter Pin—stainless steel

FORGED STEEL
YBC

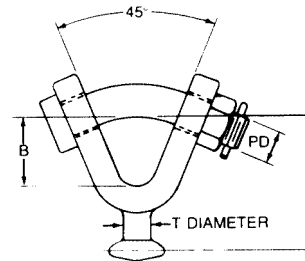

TG

CATALOG NUMBER	ULTIMATE STRENGTH LBS. (KG)	DIMENSIONS INCHES (MM)				APPROX. WT. EACH LBS. (KG)
		L	B	PD	T DIA.	
YBC-30	30,000 (13,608)	3-3/32 (78.49)	1-1/2 (35.10)	3/4 (19.05)	23/32 (18.26)	1.90 (.86)
*YBC-50	50,000 (22,680)	3-15/16 (100.20)	1-13/16 (46.04)	7/8 (22.23)	57/64 (22.62)	2.80 (1.27)

NOTE: For use with class 52-3 and 52-5 insulators per ANSI Spec. C-29.2-71.
*For use with class 52-8 and 52-11 insulators per ANSI Spec. C-29.2-71.