

INSTRUCTIONS CM308A

© Panduit Corp. 2005

PART NUMBERS

VERTICAL CABLE MANAGEMENT		Mounting Kits	Racks
Front/Back	Front Only		
WMPV22E	WMPVF22E	WMPVCBE	CMR19X47
WMPV45E	WMPVHCF45E		CMR19X84
WMPVHC45E	WMPVF45E		CMR23X84
		WMPVSMK	CMR19X84NU
			NFR84
			DR84
			NF4PR84

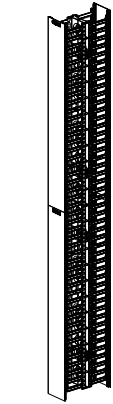

WMPV45E



WMPV22E

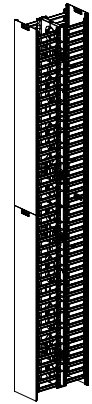

WMPVHC45E

Location Guide for Center Mounting (CMR19X84 with WMPVCBE)

Dimensions in () parenthesis are for 6" Vertical Cable Management

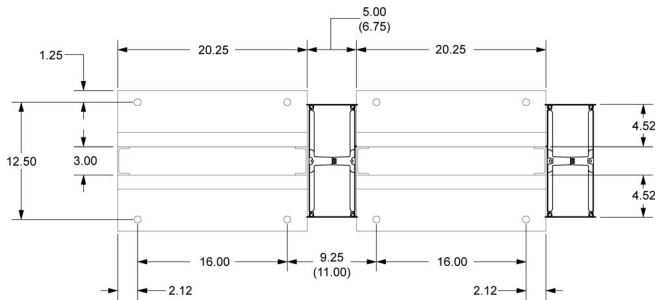

Bracket Installation

1

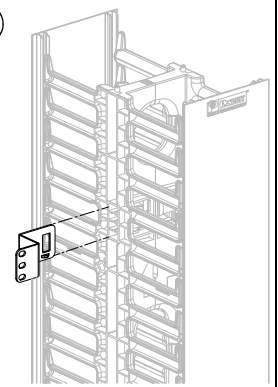

Note:

When installing between two racks use part number **WMPVCBE** for the additional brackets required. Bracket is keyed to be installed in the correct orientation.

Standard Rack Installation

2

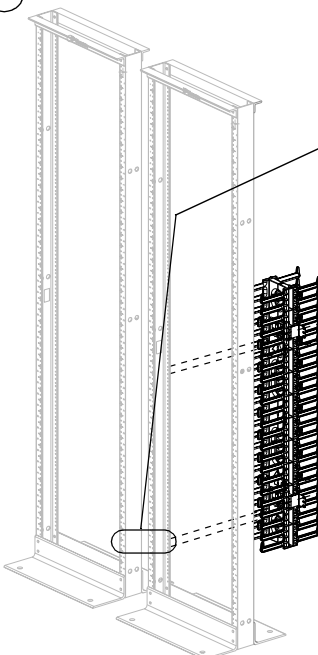

Bottom Mounting Location

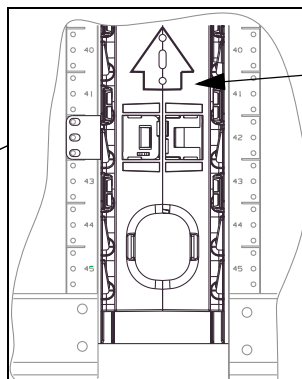

Rear Bottom Mounting Location

Note:

Arrows and flags must point upward

4

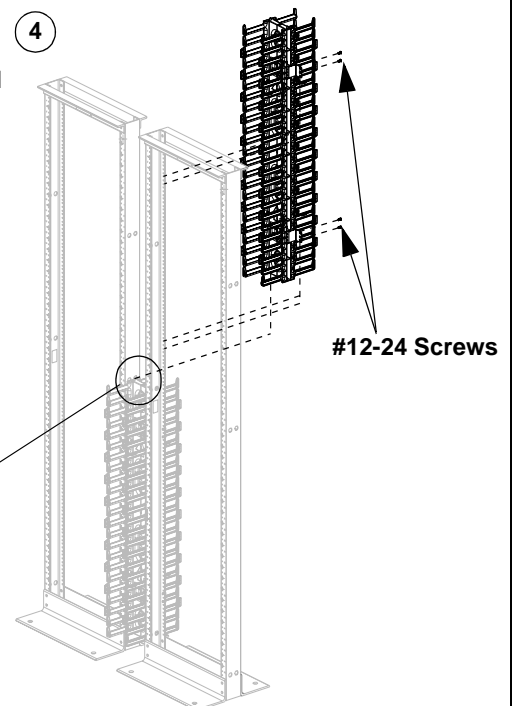

#12-24 Screws

3

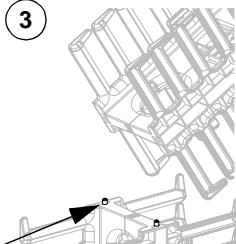

Location pin(s)

Top Mounting Location

INSTRUCTIONS CM308A

Installation Instructions NFR84, DR84 and NF4PR84 using WMPVSMK side mounting kit

Note: Mount the racks to the floor (with the appropriate space between racks indicated in the chart below)

Part Number	Space
WMPV22E WMPV45E WMPVF22E WMPVF45E	5"
WMPVHC45E WMPVHCF45E	6.75"

3/8 Bolt, Lock Washer & Nut

Location pin(s)

3/8 Bolt, Lock Washer & Nut

Opening and Closing Cover

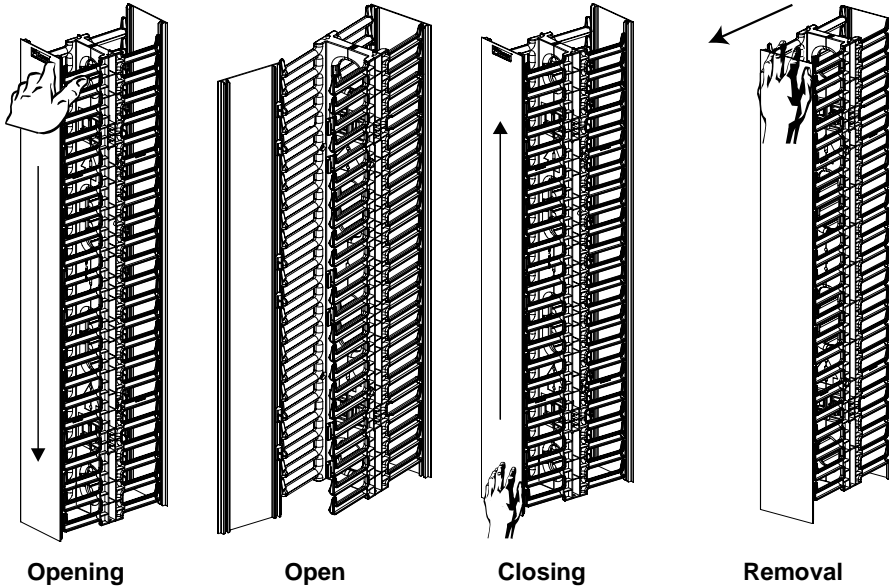

Wire Retainer Installation (WR5E)

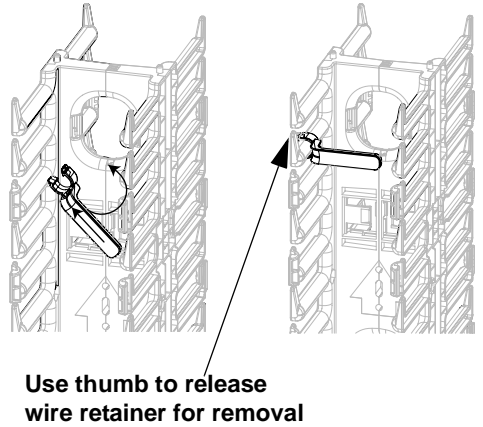

CABLE CAPACITY CHART*

Part Number	UTP Cable .187" dia.		ScTP or CAT 6 Cable .25" dia.		Channel Area	
	Front	Back	Front	Back	Front	Back
WMPVHC45E	475	475	265	265	32.7	32.7
WMPVHCF45E	475	-	265	-	32.7	-
WMPV22E	270	270	150	150	18.5	18.5
WMPV45E	270	270	150	150	18.5	18.5
WMPVF22E	270	-	150	-	18.5	-
WMPVF45E	270	-	150	-	18.5	-

NOTE: These capacity estimates represent the maximum number of cables that can be routed through the NetRunner™ vertical channels in an ideal vertical pass-through application. These figures do not account for routing inefficiencies such as cable bundling, slack management, and the entrance/exit of cables through the finger slot openings.

*Capacity = $\frac{\text{Channel Area}}{\text{Area of One Cable}} \times 40\% \text{ Fill Factor}$

For instructions in Local Languages
and Technical Support:

www.panduit.com/resources/install_maintain.asp



www.panduit.com

E-mail:
cs@panduit.com
Fax:
(708)444-6448