

15/25kV	600A Deadbreak Insulated Parking Bushing	K650SOP
---------	---	---------



Features:

- Fully rated 15/25kV, 600 Amp Deadbreak Insulated Parking Bushing
- Allows visible external separation, isolation, and dead-ending
- Stainless Steel Bracket
- Hot Stick Operable

K650SOP Insulated Parking Bushing

Applications:

The Elastimold® K650SOP Insulated Parking Bushing is equipped with a 15/25kV class, 600 A deadbreak interface, a parking stand and hot stick operable mounting hardware. The K650SOP is inserted into the parking stand with an insulated hot stick and secured in place. Mating Elastimold® K655LR/K656LR deadbreak elbows can then be placed on the K650SOP to provide a fully shielded and fully submersible connection. Provisions for grounding the K650SOP mounting bracket are included.

Ratings:

Meets ANSI/IEEE Standard 386, Latest Revision

For 15kV Voltage Class:

8.3kV Max Phase-to-Ground – Operating Voltage
 14.4kV Max Phase-to-Phase
 95kV BIL – Impulse Withstand (1.2 x 50 microsecond wave)
 34kV AC – One minute withstand
 53kV DC – 15 minutes withstand
 11kV AC – Corona Extinction @ 3pC sensitivity
 600 Amp – Continuous
 25kA Sym – 10 Cycles Momentary

For 28kV Voltage Class:

16.2kV Max Phase-to-Ground – Operating Voltage
 28kV Max Phase-to-Phase
 140kV BIL – Impulse Withstand (1.2 x 50 microsecond wave)
 45kV AC – One minute withstand
 84kV DC – 15 minutes withstand
 21.5kV AC – Corona Extinction @ 3pC sensitivity
 600 Amp – Continuous
 25kA Sym – 10 Cycles Momentary

15/25kV	600A Deadbreak Insulated Parking Bushing	K650SOP
---------	---	---------

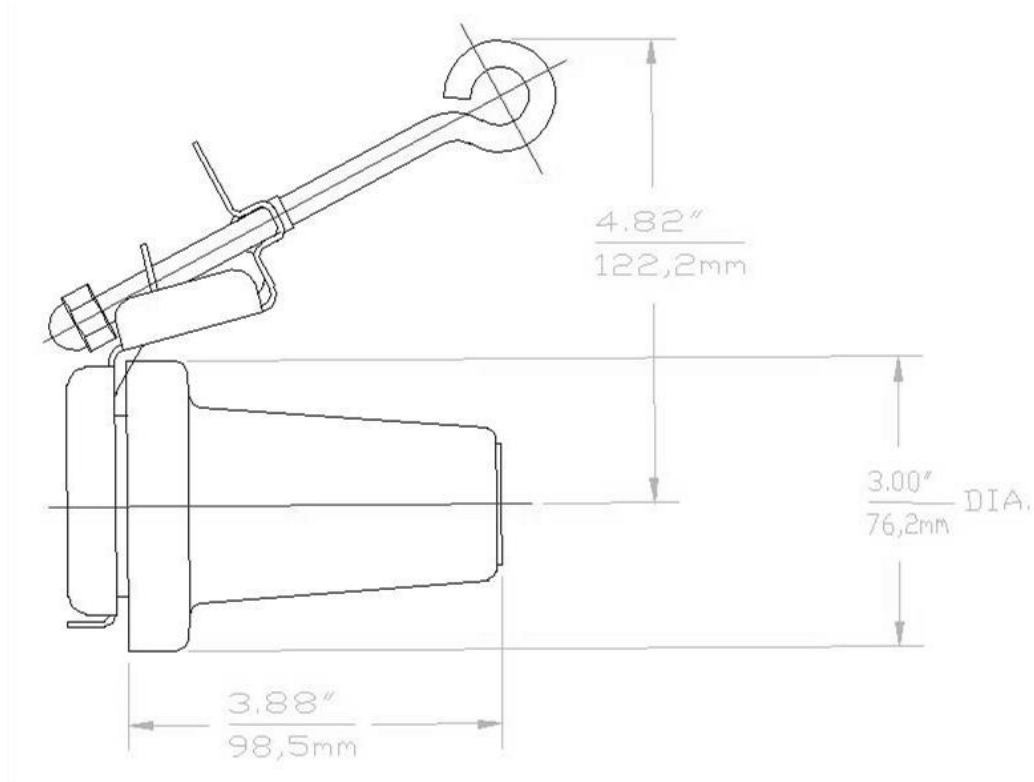

Ordering Instructions:

To order 15/25kV, 600A insulated parking bushing, specify **K650SOP**.

Each kit contains the following:

- | | | |
|---|---------------------------|---------|
| 1 | Insulated Parking Bushing | K650SOP |
| 1 | Tube, Lubricant | 82-08 |
| 1 | Installation Instruction | IS-0243 |

Example:

The ordering number for a 600 Amp insulated parking bushing is K650SOP.