



# Rapid Start T12

## F96T12/DX/HO/ALTO 15PK

Philips T12 fluorescent lamps provide high performance and long life in a wide range of sizes, shapes, and types.

### Product data

General Information	
Cap-Base	R17D [ R17d (RDC)]
Life 3-Hr Start [Hrs]	12000 h
Features	ALTO® (ALTO)

Light Technical	
Color Code	57
Initial lumen (Nom)	6750 lm
Design Mean Lumens	5800 lm
Correlated Color Temperature (Nom)	6500 K
Color Rendering Index (Nom)	90

Operating and Electrical	
Power (Rated) (Nom)	110 W

Mechanical and Housing	
Cap-Base Information	Green Base

Nominal Length (Inch)	96
-----------------------	----

Approval and Application	
Mercury (Hg) Content (Nom)	6.8 mg

Product Data	
Order product name	F96T12/DX/HO/ALTO 15PK
EAN/UPC - Product	046677214890
Order code	214890
Numerator - Quantity Per Pack	1
Numerator - Packs per outer box	15
Material Nr. (12NC)	927894705701
Net Weight (Piece)	0.001 kg

### Warnings and Safety

- Lamp contains mercury. Manage in Accord with Disposal Laws. See: [www.lamprecycle.org](http://www.lamprecycle.org) or 1-800-555-0050

## Rapid Start T12

### Dimensional drawing

#### Product

F96T12/DX/H/ALTO 15PK

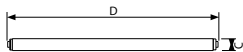

T12 Revised Double Contact

**F96T12 110W/57 HO ALTO®**

