

# Carlton®

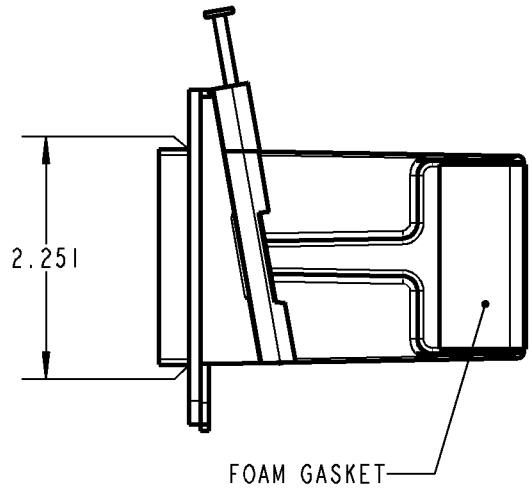
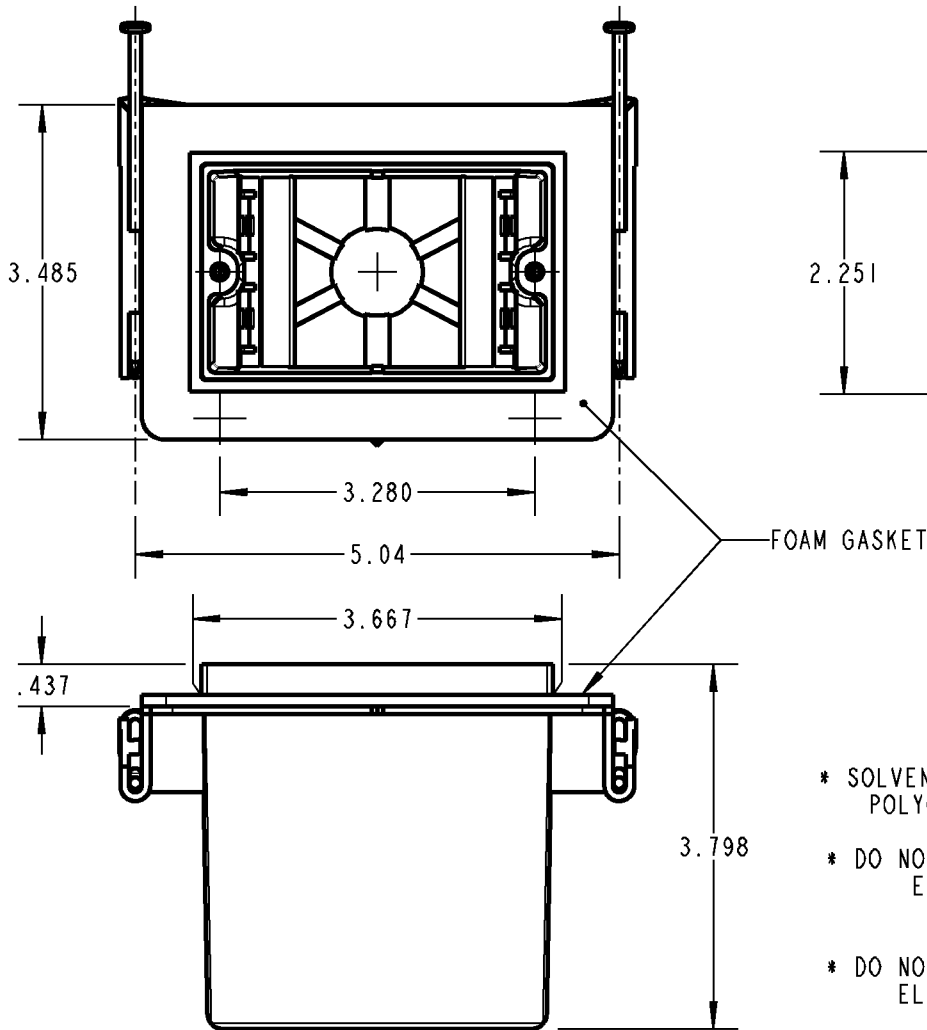
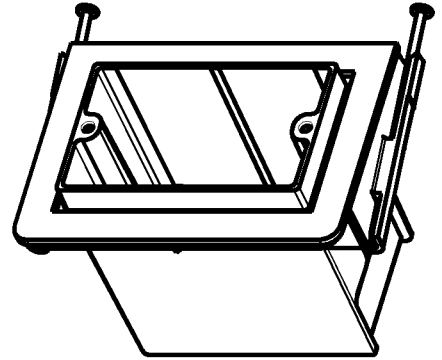

## WARNING!

- \* SOLVENTS CANNOT BE APPLIED TO ANY POLYCARBONATE ELECTRICAL BOXES.
- \* DO NOT SPRAY PAINT POLYCARBONATE ELECTRICAL BOXES WITH ANY SOLVENT-BASED PAINT.
- \* DO NOT SPRAY PAINT POLYCARBONATE ELECTRICAL BOXES WITH SPRAY PAINT APPLICATION WHICH INCLUDES ANY SOLVENT.

### GENERAL NOTES

1. ALL DIMENSIONS ARE FOR REFERENCE ONLY.
2. DIMENSIONS IN BRACKETS [ ] ARE IN METRIC UNITS.

### REVISIONS

\*\*\* SEE ERN ( \*\*\*\* ) FOR APPROVAL SIGNATURES & RELEASE DATE.  
PROJECT NO: \*\*\*\*

www.tnb.com

DESCRIPTION:

**FN-23 1-GANG NON-METALLIC  
NAIL-ON BOX W/ FLANGE & GASKETS**

ORIGINAL PROJECT NO / ( ERN NO )

**NM400330 / ( 2016537 )**

SHEET NO:

**1 OF 1**

REV. NO:

**\*\***

**Thomas & Betts**

A Member of the ABB Group

DRAWING NO:

**WSD-001502**