

15kV	600/200A Loadbreak Elbow Tap Plug	650ETP
------	-----------------------------------	--------



Features:

- 15kV Tap, 200 Amp Loadbreak Rated
- Includes hex-broach for torque in installation
- Peroxide-cured insulation and jacket
- Loadbreak interface is designed for energized operation

650ETP Loadbreak Elbow Tap Plug

Applications:

The Elastimold® 15kV 650ETP elbow tap plug permits a 200 Amp tap off of a mating 600 Amp connector. The 650ETP is installed with a 600ATM assembly tool.

The Elastimold® 650ETP mates with the following products (along with their test point models):

- 167DR
- 167DRG
- 167ESA-XX
- 165LR
- 165LRJS
- 167ELR
- 167RLR
- 167DLR
- 167DELR
- 160GLR

Ratings:

Meets ANSI/IEEE Standard 386, Latest Revision

For 15kV Voltage Class:

8.3kV Max Phase-to-Ground – Operating Voltage
14.4kV Max Phase-to-Phase
95kV BIL – Impulse Withstand (1.2 x 50 microsecond wave)
34kV AC – One minute withstand
53kV DC – 15 minutes withstand
11kV AC – Corona Extinction @ 3pC sensitivity

200 A Loadbreak Interface

200 Amp – Continuous and Loadbreak
10kA Sym – 10 Cycle Momentary & Fault Close

600 A Deadbreak Interface

600 Amp – Continuous
25kA Sym – 10 Cycle Momentary

Issue Date: 10/29/2012

Page: 2 of 2

File: PSS-650ETP

15kV	600/200A Loadbreak Elbow Tap Plug	650ETP
------	-----------------------------------	--------

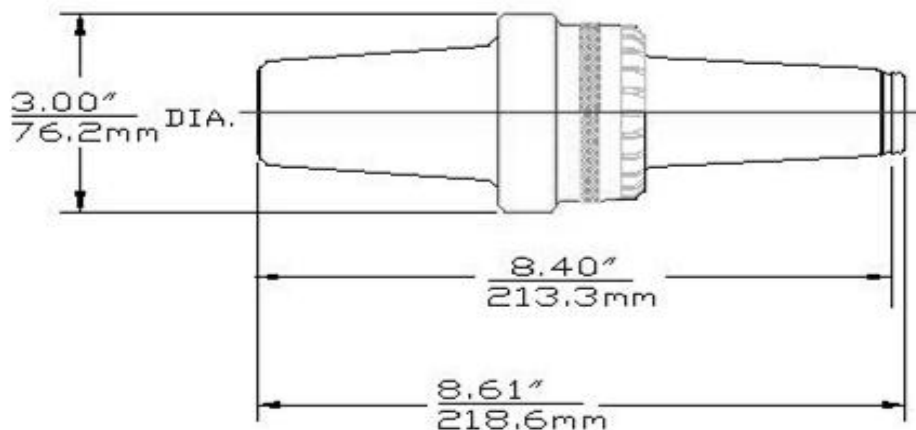

Ordering Instructions:

To order, specify number **650ETP** loadbreak elbow tap plug.

Each kit contains the following:

1	Bushing Insert	650ETP
1	Protective shipping cap	1601-APC-1
2	Lubricant	82-08
1	Installation Instruction	IS-0766

Notes:

- Available with stud factory-assembled by adding "SP" to the part number
- Available with a loose stud by adding suffix "S" to the part number
- Use 600ATM assembly tool