

| AWG    | (mm) <sup>2</sup> | (mm) | (mm) | (N.m) | (lb.ft) |
|--------|-------------------|------|------|-------|---------|
| 1..2.5 | 18...14           | 8    | 5/16 | 1,7   | 15      |
| 1..6   | 18...10           | 10   | 3/8  | 1,7   | 15      |
| 1..4   | 18...10           | 10   | 3/8  | 1,7   | 15      |

LR.D01 to LR.D21

| AWG     | (mm) <sup>2</sup> | (mm) | (mm) | (N.m) | (lb.ft) |
|---------|-------------------|------|------|-------|---------|
| 1..2.5  | 18...14           | 8    | 5/16 | 1,7   | 15      |
| 2.5..10 | 14...9            | 10   | 3/8  | 2,5   | 20      |
| 1..5..8 | 16...10           | 10   | 3/8  | 2,5   | 20      |

LR.D22 to LR.D35

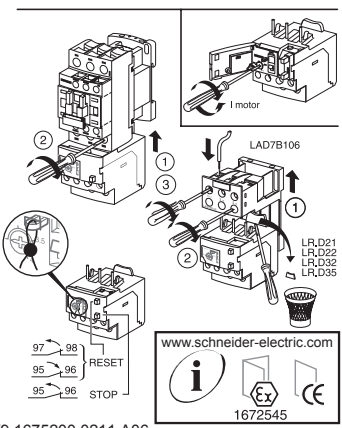

W9 1675200 0211 A06  
07 - 2012

**⚠ WARNING**  
**RISK OF FIRE OR ELECTRIC SHOCK (FOR CONTACTOR WITH UL-HI-Fault SHORT CIRCUIT CURRENT RATINGS ONLY)**  
 The opening of the branch-circuit protective device may be an indication that a fault current has been detected. To reduce the risk of fire or electrical shock, current-carrying parts and other components of the device may become extremely hot. Failure to follow these instructions can result in death, serious injury, or equipment damage.

| AWG    | (mm) <sup>2</sup> | (mm) | (mm) | (N.m) | (lb.ft) |
|--------|-------------------|------|------|-------|---------|
| 1..2.5 | 18...14           | 8    | 5/16 | 1,7   | 15      |
| 1..6   | 18...10           | 10   | 3/8  | 1,7   | 15      |
| 1..4   | 18...10           | 10   | 3/8  | 1,7   | 15      |
| 8      | 5/16              | 12   | 1/2  | 5,8   | 3/8     |

LR.D016 to LR.D216

| AWG     | (mm) <sup>2</sup> | (mm) | (mm) | (N.m) | (lb.ft) |
|---------|-------------------|------|------|-------|---------|
| 1..2.5  | 18...14           | 8    | 5/16 | 1,7   | 15      |
| 2.5..10 | 14...9            | 10   | 3/8  | 2,5   | 20      |
| 1..5..8 | 16...10           | 10   | 3/8  | 2,5   | 20      |
| 8       | 5/16              | 12   | 1/2  | 5,8   | 3/8     |

LR.D226 to LR.D356