

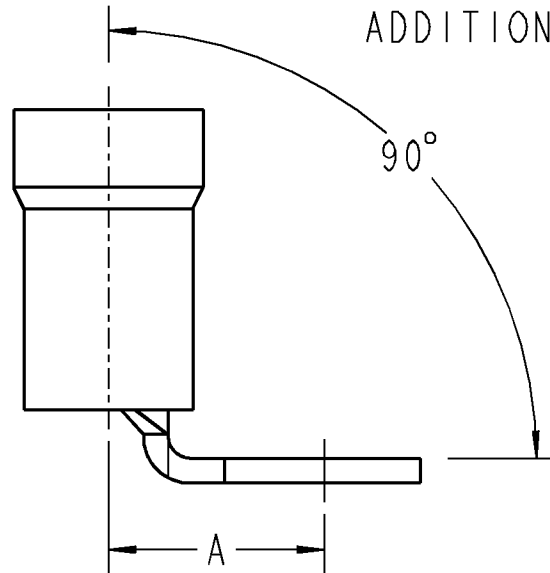

CATALOG No.	DIM. A	WIRE RANGE	BOLT HOLE
RD167U	.370	8	#8
RD367U	.370	8	#10
RD717U	.450	8	1/4
RE267U	.390	6	#10
RE267SU	.390	6	#10
RE717U	.390	6	1/4

ALL DIMENSIONS ARE APPROXIMATE.

REF. WSD-000208 FOR ADDITIONAL DIMENSIONS.



NOTES:

1. MATERIAL: ELECTROLYTIC COPPER
2. FINISH: TIN PLATED
3. NYLON INSULATOR
4. SAME AS STANDARD T&B CATALOG NUMBER BUT WITH A "U" SUFFIX FOR 90° BEND.
5. INSTALLATION TOOLS: REFERENCE SALES DWG WSD-000208
6. ALSO APPROVED FOR CLASS I FLEXIBLE WIRE.

GENERAL NOTES		Thomas & Betts <small>www.tnb.com</small>			
1. ALL DIMENSIONS ARE FOR REFERENCE ONLY. 2. DIMENSIONS IN BRACKETS [] ARE IN METRIC UNITS.					
REVISIONS		DESCRIPTION: NYLON INSULATED RING TERMINAL, 90° UPRIGHT BEND			
1	SEE ERN (2007987) FOR APPROVAL SIGNATURES & RELEASE DATE. PROJECT NO: TM401341	ORIGINAL PROJECT NO / (ERN NO) TM401323 / (2004841)	SHEET NO: 1 OF 1	REV. NO: 1	DRAWING NO: WSD-000094