

15kV	200A Loadbreak Vertical Feed-Thru	164FTV
------	-----------------------------------	--------



Note: Red PBT Interface Shield available soon

Features:

- 15kV, 200 Amp Loadbreak Rated
- Uses integral parking stand mount
- Provide extra tap for elbow arrester connection
- Peroxide-cured insulation and jacket
- Optional accessories allow isolation, testing, and grounding
- Space saving vertical mounting design for small spaces

164FTV Loadbreak Vertical Feed-Thru

Applications:

The Elastimold® 164FTV vertical feed-thru is a space saving design for congested areas inside transformers or switchgear. The 164FTV is a fully shielded, fully submersible, separable insulated connector designed for energized operation. It is suitable for use on 15kV class loadbreak systems. When used in conjunction with 15kV class elbow connectors, the 164FTV provides the circuit with the loadbreak junction point. Testing and grounding of the circuit is accomplished when the 164FTV is used in conjunction with the 370TR and 160GLR. When used in conjunction with a 160DR the 164FTV can be used to isolate and "dead-end" the circuit. The 164FT is designed to mate with the following Elastimold® products:

- 15kV Family of Elbow Connectors
- 370TR test rod
- 160GLR grounding elbow
- 160DR/DRG insulated cap

Ratings:

Meets ANSI/IEEE Standard 386, Latest Revision

For 15kV Voltage Class:

8.3kV Max Phase-to-Ground – Operating Voltage
 14.4kV Max Phase-to-Phase
 95kV BIL – Impulse Withstand (1.2 x 50 microsecond wave)
 34kV AC – One minute withstand
 53kV DC – 15 minutes withstand
 11kV AC – Corona Extinction @ 3pC sensitivity
 200 Amp – Continuous and Loadbreak
 10kA Sym – 10 Cycles Momentary & Fault Close

15kV	200A Loadbreak Vertical Feed-Thru	164FTV
------	-----------------------------------	--------

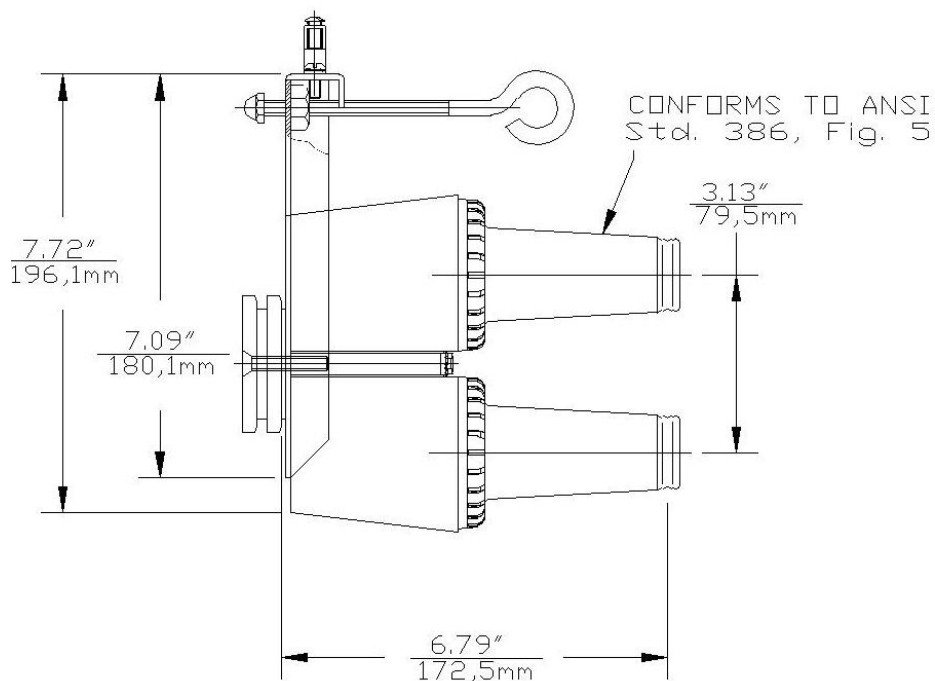

Ordering Instructions:

To order, specify number **164FTV** feed-thru.

Each kit contains the following:

- | | | |
|---|--------------------------|------------|
| 1 | Feed-thru body | 164FTV |
| 2 | Protective shipping cap | 1601-APC-1 |
| 2 | Lubricant | 82-08 |
| 1 | Installation Instruction | IS-0377 |