

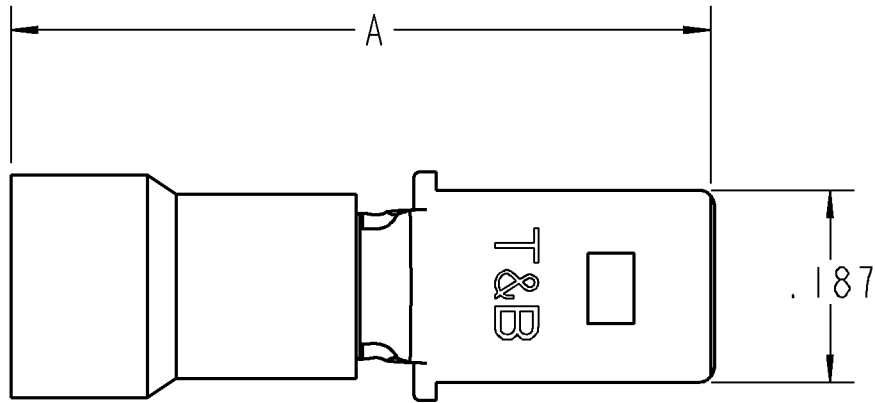

T&B Sta-Kon



TONGUE MATERIAL: BRASS
 INSULATING SLEEVE: VINYL
 FINISH: TIN PLATED

INSTALLING TOOLS: WT145C, WT2000, ERG-2001, ERG-2003, WT112M

ALL DIMENSIONS ARE APPROXIMATE, FOR REFERENCE ONLY.

CATALOG	WIRE RANGE	STOCK THICKNESS	DIM. A.
18RAD-187	22-18	.032	.87
18RAD-188	22-18	.020	.87
14RBD-187	16-14	.032	.87
14RBD-188	16-14	.020	.87

GENERAL NOTES

- ALL DIMENSIONS ARE FOR REFERENCE ONLY.
- DIMENSIONS IN BRACKETS [] ARE IN METRIC UNITS.

REVISIONS

*** SEE ERN (****) FOR APPROVAL SIGNATURES & RELEASE DATE.
 PROJECT NO: ****

Thomas & Betts
 www.tnb.com

DESCRIPTION: **187 SERIES MALE TABS
 VINYL INSULATED**

ORIGINAL PROJECT NO / (ERN NO)	SHEET NO:	REV. NO:	DRAWING NO:
TM401330 / (2006774)	1 OF 1	-	WSD-000278