

Cord Grip Connectors

Type CGA

Straight Strain Relief

Features:

- Tapered threaded male hub NPT
- Watertight/Oiltight
- With Neoprene grommets
- Rated at 90°C

Material/Finish:

Copper Free Aluminum

Third Party Certification:

 UL Listed: E-11857

Applicable Third Party Standards:

UL Standard: 514B
 CSA Standard: C22.2 No. 18
 Fed. Spec.: Commercial Item Description
 A-505-52

Note:

Consult your local representative for cable ranges not listed or multi-hole applications.

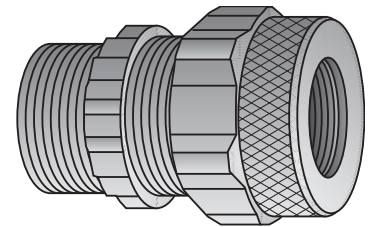
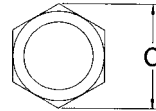
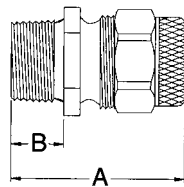

Type CGA-38

Catalog Number	Dimensions in Inches			Dimensions in Inches		
	Cable Range Dia. Over Jacket Min. Max.	Hub Size	Throat I.D.	A Body Length	B Thread Length	C Max. Dia.
CGA-38-188	0.125 - 0.188	3/8	0.46	1 1/2	7/16	1
CGA-38-250	0.188 - 0.250	3/8	0.46	1 1/2	7/16	1
CGA-38-312	0.250 - 0.312	3/8	0.46	1 1/2	7/16	1
CGA-38-375	0.312 - 0.375	3/8	0.46	1 1/2	7/16	1
CGA-38-438	0.375 - 0.438	3/8	0.46	1 1/2	7/16	1
CGA-50-188	0.125 - 0.188	1/2	0.58	1 13/16	1/2	1 5/16
CGA-50-250	0.188 - 0.250	1/2	0.58	1 13/16	1/2	1 5/16
CGA-50-312	0.250 - 0.312	1/2	0.58	1 13/16	1/2	1 5/16
CGA-50-375	0.312 - 0.375	1/2	0.58	1 13/16	1/2	1 5/16
CGA-50-438	0.375 - 0.438	1/2	0.58	1 13/16	1/2	1 5/16
CGA-50-500	0.438 - 0.500	1/2	0.58	1 13/16	1/2	1 5/16
CGA-50-562	0.500 - 0.562	1/2	0.58	1 13/16	1/2	1 5/16
CGA-50-625	0.562 - 0.625	1/2	0.58	1 13/16	1/2	1 5/16
CGA-75-562	0.438 - 0.562	3/4	0.81	2 1/16	9/16	1 1/2
CGA-75-625	0.500 - 0.625	3/4	0.81	2 1/16	9/16	1 1/2
CGA-75-688	0.562 - 0.688	3/4	0.81	2 1/16	9/16	1 1/2
CGA-75-750	0.625 - 0.750	3/4	0.81	2 1/16	9/16	1 1/2
CGA-75-812	0.688 - 0.812	3/4	0.81	2 1/16	9/16	1 1/2
CGA-100-562	0.438 - 0.562	1	1	2 5/16	5/8	1 11/16
CGA-100-625	0.500 - 0.625	1	1	2 5/16	5/8	1 11/16
CGA-100-688	0.562 - 0.688	1	1	2 5/16	5/8	1 11/16
CGA-100-750	0.625 - 0.750	1	1	2 5/16	5/8	1 11/16
CGA-100-812	0.688 - 0.812	1	1	2 5/16	5/8	1 11/16
CGA-100-875	0.750 - 0.875	1	1	2 5/16	5/8	1 11/16
CGA-100-938	0.812 - 0.938	1	1	2 5/16	5/8	1 11/16
CGA-125-875	0.750 - 0.875	1 1/4	1.31	2 3/4	1 1/16	2 1/2
CGA-125-1000	0.875 - 1.000	1 1/4	1.31	2 3/4	1 1/16	2 1/2
CGA-125-1125	1.000 - 1.125	1 1/4	1.31	2 3/4	1 1/16	2 1/2
CGA-125-1250	1.125 - 1.250	1 1/4	1.31	2 3/4	1 1/16	2 1/2
CGA-125-1375	1.250 - 1.375	1 1/4	1.31	2 3/4	1 1/16	2 1/2
CGA-150-875	0.750 - 0.875	1 1/2	1.5	2 3/4	1 1/16	2 1/2
CGA-150-1000	0.875 - 1.000	1 1/2	1.5	2 3/4	1 1/16	2 1/2
CGA-150-1125	1.000 - 1.125	1 1/2	1.5	2 3/4	1 1/16	2 1/2
CGA-150-1250	1.125 - 1.250	1 1/2	1.5	2 3/4	1 1/16	2 1/2
CGA-150-1375	1.250 - 1.375	1 1/2	1.5	2 3/4	1 1/16	2 1/2
CGA-200-1375	1.250 - 1.375	2	1.84	3 3/4	1 3/16	3 1/4
CGA-200-1562	1.438 - 1.562	2	1.84	3 3/4	1 3/16	3 1/4
CGA-200-1688	1.562 - 1.688	2	1.84	3 3/4	1 3/16	3 1/4
CGA-200-1812	1.688 - 1.812	2	1.84	3 3/4	1 3/16	3 1/4

Cord Grip Connectors

Type CGA

90° Strain Relief

Features:

- Tapered threaded male hub NPT
- Watertight/Oiltight
- With Neoprene grommets
- Rated at 90°C

Material/Finish:

Copper Free Aluminum

Third Party Certification:

 UL Listed: E-11857

Applicable Third Party Standards:

UL Standard: 514B
 CSA Standard: C22.2 No. 18
 Fed. Spec.: Commercial Item Description
 A-505-52

Note:

Consult your local representative for cable ranges not listed or multi-hole applications.

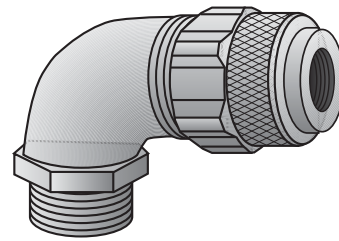
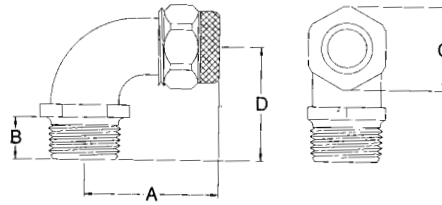

Type CGA-938

Catalog Number	Dimensions in Inches Cable Range			Dimensions in Inches				
	Dia. Over Jacket Min.	Jacket Max.	Hub Size	Throat I.D.	A	B	C	D
CGA-938-188	.125 - .188	.250	3/8	.45	1 1/2	7/16	1	1 5/16
CGA-938-250	.188 - .250	.312	3/8	.45	1 1/2	7/16	1	1 5/16
CGA-938-312	.250 - .312	.375	3/8	.45	1 1/2	7/16	1	1 5/16
CGA-938-375	.312 - .375	.438	3/8	.45	1 1/2	7/16	1	1 5/16
CGA-938-438	.375 - .438		3/8	.58	1 1/2	7/16	1	1 5/16
CGA-950-188	.125 - .188	.250	1/2	.58	1 7/8	9/16	1 5/16	1 1/2
CGA-950-250	.188 - .250	.312	1/2	.58	1 7/8	9/16	1 5/16	1 1/2
CGA-950-312	.250 - .312	.375	1/2	.58	1 7/8	9/16	1 5/16	1 1/2
CGA-950-375	.312 - .375	.438	1/2	.58	1 7/8	9/16	1 5/16	1 1/2
CGA-950-438	.375 - .438	.500	1/2	.58	1 7/8	9/16	1 5/16	1 1/2
CGA-950-500	.438 - .500	.562	1/2	.58	1 7/8	9/16	1 5/16	1 1/2
CGA-950-562	.500 - .562	.625	1/2	.58	1 7/8	9/16	1 5/16	1 1/2
CGA-950-625	.562 - .625		1/2	.58	1 7/8	9/16	1 5/16	1 1/2
CGA-975-562	.438 - .562	.625	3/4	.76	2 1/4	5/8	1 1/2	1 15/16
CGA-975-625	.500 - .625	.688	3/4	.76	2 1/4	5/8	1 1/2	1 15/16
CGA-975-688	.562 - .688	.750	3/4	.76	2 1/4	5/8	1 1/2	1 15/16
CGA-975-750	.625 - .750	.812	3/4	.76	2 1/4	5/8	1 1/2	1 15/16
CGA-975-812	.688 - .812		3/4	.76	2 1/4	5/8	1 1/2	1 15/16
CGA-9100-562	.438 - .562	.625	1	.99	2 3/8	5/8	1 11/16	2
CGA-9100-625	.500 - .625	.688	1	.99	2 3/8	5/8	1 11/16	2
CGA-9100-688	.562 - .688	.750	1	.99	2 3/8	5/8	1 11/16	2
CGA-9100-750	.625 - .750	.812	1	.99	2 3/8	5/8	1 11/16	2
CGA-9100-812	.688 - .812	.875	1	.99	2 3/8	5/8	1 11/16	2
CGA-9100-875	.750 - .875	.938	1	.99	2 3/8	5/8	1 11/16	2
CGA-9100-938	.812 - .938		1	.99	2 3/8	5/8	1 11/16	2
CGA-9125-875	.750 - .875	1.000	1 1/4	1.28	3 3/16	1 1/16	2 3/16	2 11/16
CGA-9125-1000	.875 - 1.000	1.125	1 1/4	1.28	3 3/16	1 1/16	2 3/16	2 11/16
CGA-9125-1125	1.000 - 1.125	1.250	1 1/4	1.28	3 3/16	1 1/16	2 3/16	2 11/16
CGA-9125-1250	1.125 - 1.250	1.375	1 1/4	1.28	3 3/16	1 1/16	2 3/16	2 11/16
CGA-9125-1375	1.250 - 1.375		1 1/4	1.28	3 3/16	1 1/16	2 3/16	2 11/16
CGA-9150-875	.750 - .875	1.000	1 1/2	1.40	3 3/16	1 1/16	2 3/16	2 11/16
CGA-9150-1000	.875 - 1.000	1.125	1 1/2	1.40	3 3/16	1 1/16	2 3/16	2 11/16
CGA-9150-1125	1.000 - 1.125	1.250	1 1/2	1.40	3 3/16	1 1/16	2 3/16	2 11/16
CGA-9150-1250	1.125 - 1.250	1.375	1 1/2	1.40	3 3/16	1 1/16	2 3/16	2 11/16
CGA-9150-1375	1.250 - 1.375		1 1/2	1.40	3 3/16	1 1/16	2 3/16	2 11/16
CGA-9200-1375	1.250 - 1.375	1.562	2	1.90	4	1 3/16	3 1/4	3 3/16
CGA-9200-1562	1.438 - 1.562	1.688	2	1.90	4	1 3/16	3 1/4	3 3/16
CGA-9200-1688	1.562 - 1.688	1.812	2	1.90	4	1 3/16	3 1/4	3 3/16
CGA-9200-1812	1.688 - 1.812		2	1.90	4	1 3/16	3 1/4	3 3/16

Cord Grip Connectors

With Wire Mesh Grips

Type CGA

Straight & 90° Strain Relief

Features:

- With Neoprene grommets
- Stainless steel wire mesh grips for superior cable pullout resistance
- Tapered threaded male hub NPT
- Watertight/Oiltight
- Rated at 90°C

Material/Finish:

Copper Free Aluminum

Third Party Certification:



Applicable Third Party Standards:

UL Standard: 514B
 CSA Standard: C22.2 No. 18
 Fed. Spec.: Commercial Item Description
 A-505-52

Dimension Data:

See Pages HB1, HB2

Note:

Consult your local representative for cable ranges not listed or multi-hole applications.



Type CGA-38-250M



Type CGA-938-250M

Trade Size (inches)	Straight Connectors	90 Degree Connectors	Cord Range
3/8	CGA-38-250M	CGA-938-250M	.188 - .250
3/8	CGA-38-312M	CGA-938-312M	.250 - .312
3/8	CGA-38-375M	CGA-938-375M	.312 - .375
3/8	CGA-38-438M	CGA-938-438M	.375 - .438
1/2	CGA-50-250M	CGA-950-250M	.188 - .250
1/2	CGA-50-312M	CGA-950-312M	.250 - .312
1/2	CGA-50-375M	CGA-950-375M	.312 - .375
1/2	CGA-50-438M	CGA-950-438M	.375 - .438
1/2	CGA-50-500M	CGA-950-500M	.438 - .500
1/2	CGA-50-562M	CGA-950-562M	.500 - .562
1/2	CGA-50-625M	CGA-950-625M	.562 - .625
3/4	CGA-75-562M	CGA-975-562M	.438 - .562
3/4	CGA-75-625M	CGA-975-625M	.500 - .625
3/4	CGA-75-688M	CGA-975-688M	.562 - .688
3/4	CGA-75-750M	CGA-975-750M	.652 - .750
3/4	CGA-75-812M	CGA-975-812M	.688 - .812
1	CGA-100-562M	CGA-9100-562M	.438 - .562
1	CGA-100-625M	CGA-9100-625M	.500 - .625
1	CGA-100-688M	CGA-9100-688M	.562 - .688
1	CGA-100-750M	CGA-9100-750M	.625 - .750
1	CGA-100-812M	CGA-9100-812M	.688 - .812
1	CGA-100-875M	CGA-9100-875M	.750 - .875
1	CGA-100-938M	CGA-9100-938M	.812 - .938
1 1/4	CGA-125-1000M	CGA-9125-1000M	.875 - 1.000
1 1/4	CGA-125-1125M	CGA-9125-1125M	1.000 - 1.125
1 1/4	CGA-125-1250M	CGA-9125-1250M	1.125 - 1.250
1 1/4	CGA-125-1375M	CGA-9125-1375M	1.250 - 1.375
1 1/2	CGA-150-1000M	CGA-9150-1000M	.875 - 1.000
1 1/2	CGA-150-1125M	CGA-9150-1125M	1.000 - 1.125
1 1/2	CGA-150-1250M	CGA-9150-1250M	1.125 - 1.250
1 1/2	CGA-150-1375M	CGA-9150-1375M	1.250 - 1.375
2	CGA-200-1562M	CGA-9200-1562M	1.438 - 1.562
2	CGA-200-1688M	CGA-9200-1688M	1.562 - 1.688
2	CGA-200-1812M	CGA-9200-1812M	1.688 - 1.812