

Transition Couplings

For Rigid Metal Conduit and IMC to EMT or Flexible Metal Conduit

Type ETR

Features:

- Threaded RMC and IMC to compression EMT
- Concretetight
- NPT female hub

Material/Finish:

Malleable Iron/Zinc Plated

Third Party Certification:

 UL Listed: E-11853

Applicable Third Party Standards:

UL Standard: 514B
Fed. Spec: W-F-408E

Trade Size (inches)	Catalog Number	Dimensions in Inches	
		Length	Max Dia.
1/2	ETR-50	1 1/8	1 1/8
3/4	ETR-75	1 5/16	1 3/8
1	ETR-100	1 1/2	1 3/4
1 1/4	ETR-125	1 7/8	2 1/8
1 1/2	ETR-150	1 7/8	2 1/2
2	ETR-200	2 1/16	3

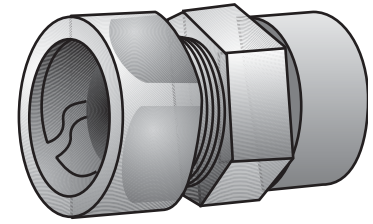

Type ETR

Type ESR

Features:

- Concretetight
- Set screw
- Threadless RMC and IMC to EMT

Material/Finish:

Malleable Iron/Zinc Plated

Third Party Certification:

 UL Listed: E-11853

Applicable Third Party Standards:

UL Standard: 514B
Fed. Spec: W-F-408E

Trade Size (inches)	Catalog Number	Dimensions in Inches		
		A	B	C
1/2	ESR-50	1 1/16	1 5/16	1 1/4
3/4	ESR-75	2 1/16	1 1/8	1 1/2
1	ESR-100	2 1/2	1 3/8	1 13/16

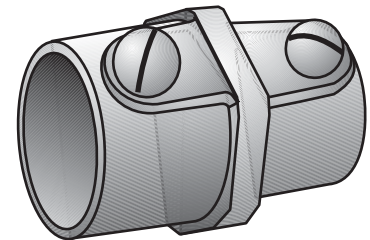
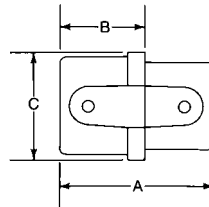

Type ESR

Type CB

Features:

- Threaded RMC and IMC to Flexible Metal Conduit
- NPT female hub

Material/Finish:

Malleable Iron, Zinc Plated

Third Party Certification:

 UL Listed: E-11853

 CSA Certified: 009795

Applicable Third Party Standards:

UL Standard: 514B
CSA Standard: C22.2 No. 18
Fed. Spec: W-F-408E

Trade Size (inches)	Catalog Number	Dimensions in Inches		
		Length	Max Dia.	Flex. Range
1/2	CB-50	1 1/2	1 1/4	25/32 - 15/16
3/4	CB-75	1 3/4	1 1/2	29/32 - 15/64
1	CB-100	1 7/8	1 7/8	1 1/32 - 1 1/16

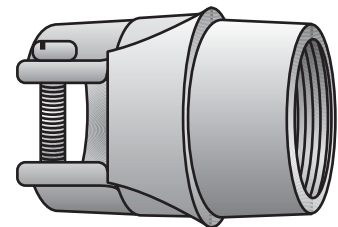

Type CB