

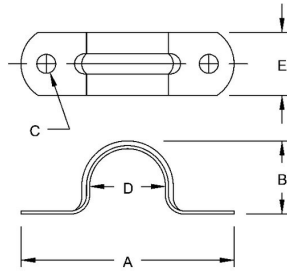

**EMT STRAPS - STEEL**

Two Hole Straps Stamped Steel  
N/A

B22



Catalog #: 2092

**APPLICATIONS**

For use in mounting EMT conduit  
N/A

**PRODUCT FEATURES**

All stamped steel construction insures mechanical protection  
Oversized bolt holes make alignment of the fastener quick and easy  
All straps are zinc electro plated for corrosion protection

**GENERAL PRODUCT INFORMATION**

Trade Size: 1/2 in.

**DRAWING DIMENSIONS**

Dimension A: 2.140 in.  
Dimension B: .750 in.  
Dimension C: .187 in.  
Dimension D: .706 in.  
Dimension E: .625 in.

**PACKAGING**

Package Type: Carton  
Ship Carton Qty.: 100  
Product UPC-A Labeled: No  
Weight (Lbs. Per/C): 2.30  
Ship Carton Length (in.): 9.20  
Ship Carton Width (in.): 6.40  
Ship Carton Height (in.): 4.70  
Ctn Weight (Lbs.): 2.30  
UPC Number: 050169020920  
I2of5: 50050169020925