

25508

1/4-20 X 1/2 STOVE BOLT ZINC

UPC: 085937255082

Country of Origin:

UNSPSC: 31161504

USA

Commodity: Machine screws

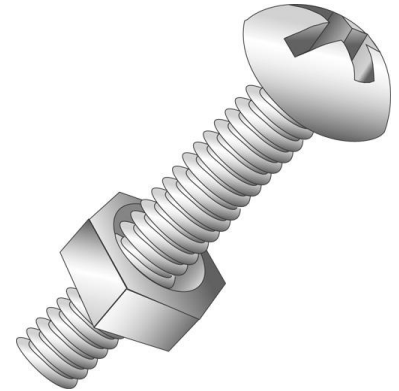

A straight shank fastener with external threads designed to go through a hole or nut that is pre-tapped to form a mating thread for the screw.

Product Attributes

Brand Name	Minerallac Company
Sub Brand	Cully
Type	Stove Bolt
Material	Steel
Size	1/4-20 x 1/2" IN
Length	0.500" IN
Thread Type	Coarse
Thread Size	20 TPI
Head Height	0.181" IN
Head Type	Hex Head
Head Color	Silver
Finish	Zinc Plated
Drive Type	Combo Slotted/Phillips
Head Diameter	0.458" IN

Item Status: Active
Standard Qty: 100

Minerallac Company

Tel: 800-927-3293
Fax: 800-824-8942
www.minerallac.com