

LINE TERMINAL DETAIL

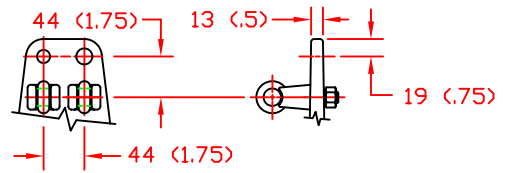

CLAMP-TYPE TERMINAL FOR USE WITH  
 Cu OR Al CONDUCTOR  
 7 (.25) - 21 (.81) DIA  
 25 - 240 sq mm  
 AWG#4 - 500 MCM

GROUND TERMINAL DETAIL

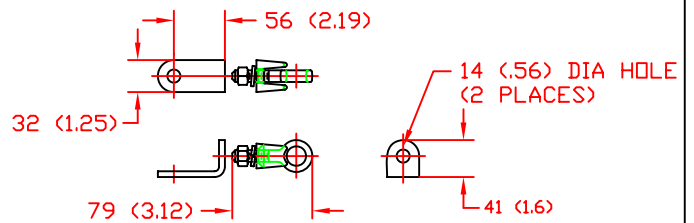

CLAMP-TYPE TERMINAL FOR USE WITH  
 Cu OR Al CONDUCTOR  
 7 (.25) - 21 (.81) DIA  
 25 - 240 sq mm  
 AWG#4 - 500 MCM

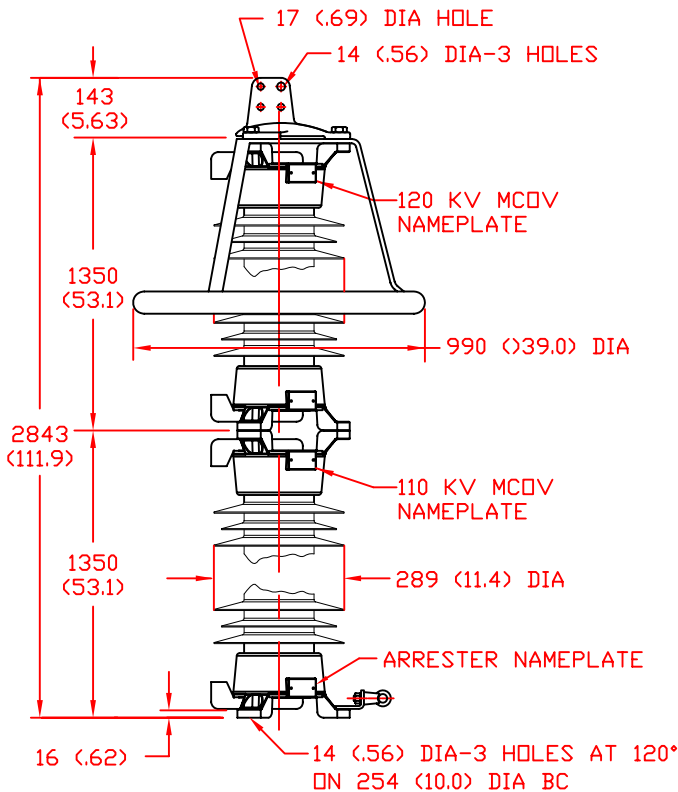

CHARACTERISTICS	
RATED VOLTAGE, $U_r$	288 kVrms
MCOV, $U_c$	230 kVrms
MASS	163kg (358lb)
LEAKAGE DISTANCE	8740 (344)
LIGHTNING IMP W/S	1380 kV
SWITCHING IMP W/S	1000 kV
POWER FREQ W/S	710 kVrms
HOUSING	GREY SILICONE

NOTES:

1. DIMENSIONS ARE MM (IN) UNLESS NOTED OTHERWISE
2. DIMENSIONS SUBJECT TO ±3% TOLERANCE

.5 μ SEC 10kA IR KV	500 A SWITCHING SURGE IR KV	MAXIMUM 8/20 DISCHARGE VOLTAGE - kV AT					
		1.5 kA	3.0 kA	5 kA	10 kA	20 kA	40 kA
730	571	566	594	619	661	716	797

STATION CLASS  
 SURGE ARRESTER

OHIO BRASS  
 TOLERANCE CHART



HUBBELL® POWER SYSTEMS

CONFIDENTIAL: THIS DRAWING AND ITS CONTENTS ARE CONFIDENTIAL AND THE EXCLUSIVE PROPERTY OF HUBBELL POWER SYSTEMS. NO PUBLICATION, DISTRIBUTION OR COPIES MAY BE MADE WITHOUT THE WRITTEN CONSENT OF HUBBELL POWER SYSTEMS. HUBBELL POWER SYSTEMS UNPUBLISHED ALL RIGHTS RESERVED UNDER THE COPYRIGHT LAWS.

TITLE SVN ARRESTER 230 KV MCOV			
SIZE S	DWG NO. --	CAT / PART / ASSY NO. SVN288GA230AA	REV 0
DO NOT SCALE THIS DRAWING	DRN BY JVR	DATE 04/04/08	SHEET 1 OF 1

REV DATE  
 04/04/08