



**POWER
SYSTEMS, INC.**

**Interactive
eCatalog**

In the world of power transmission and distribution, look to Hubbell.

[Catalog Home](#)

Product Datasheet

ANDERSON FARGO

CEEL093065 -- Clevis Eye Link



Clevis Eye Link, Ductile Iron, Clevis Opening , Clevis Pin 0.750 in, Eye 0.813 in, Eye Hole 0.813 in, UTS 50,000 lb

Product Specifications

Hardware Family

Photo of Cat
ES-7819-15.66



Straps & Long Clevis
Extension Links

Straps & Clevis Eye Links



CEEL Series
Clevis Eye, Long
Extension Links

PDF Catalog Page

[Click HERE to view the web page.](#)

Ultimate Strength

50,000 lb (22,680 kg)

Coupling Length

9.375 in (238.1 mm)

Eye Hole Diameter

0.813 in (20.64 mm)

Dimension B

6.000 in (152.40 mm)

Dimension C

0.813 in (20.64 mm)

Dimension D

1.375 in (34.92 mm)

Dimension W

1.000 in (25.40 mm)

Dimension PD

0.750 in (19.05 mm)

Material

Ductile Iron

Cotter Pin Material

Stainless Steel

Clevis Pin Material

Galvanized Steel

Material Type

Non-Standard

UPC Code

09635929854

Standard Package

12

Standard Package Unit

Each

Min Order Qty

1

Weight / Ea.

5.88 lbs

Compressed Product Number

CEEL093065

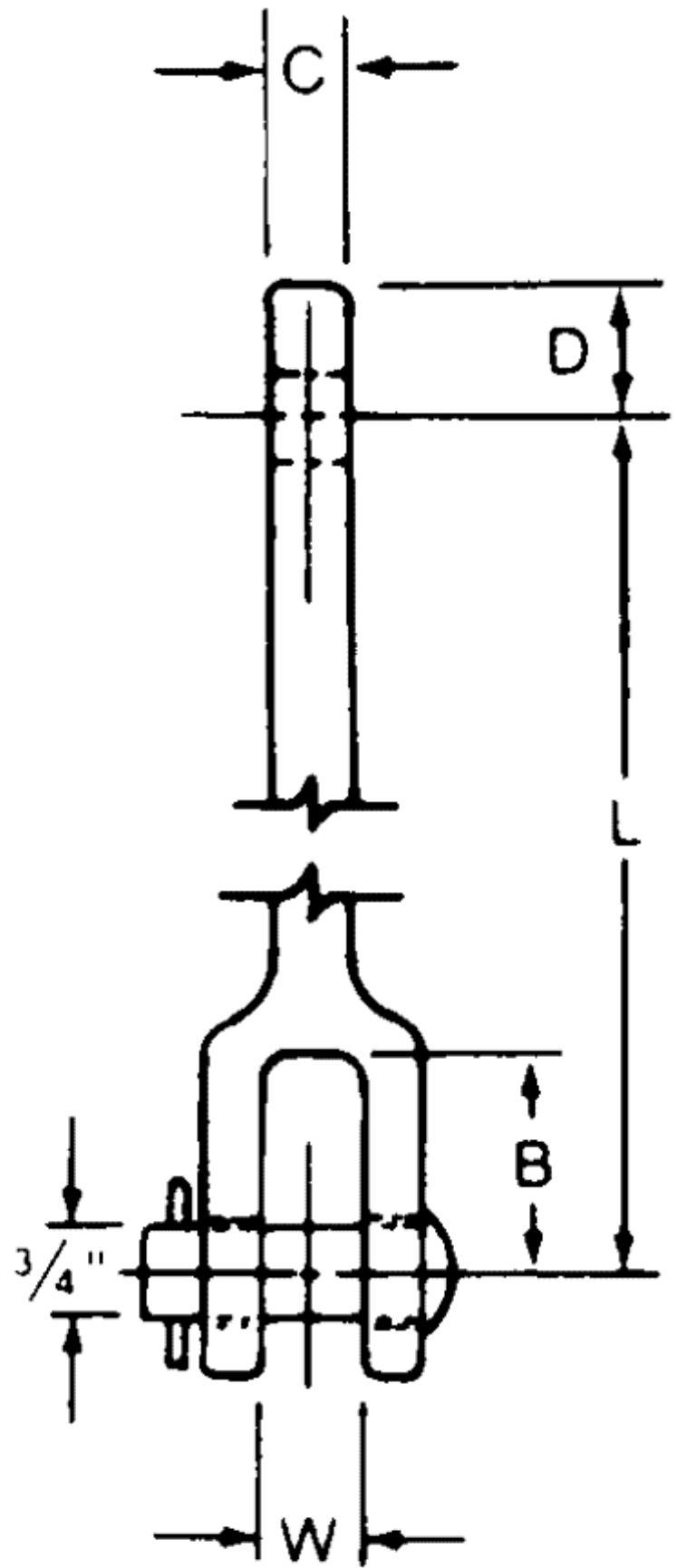
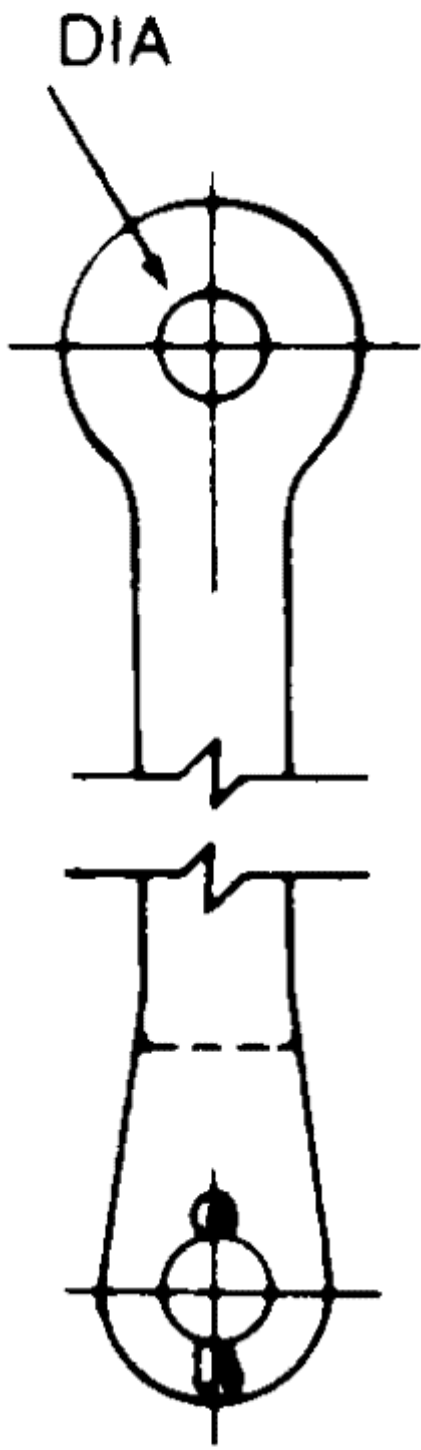

CEEL



[Warranty Info](#) | [Trademarks](#) | [Terms of Use](#)

All contents Copyright © 2007 Hubbell Power Systems, Inc. All rights reserved.

NOTE: Because Hubbell has a policy of continuous product improvement, we reserve the right to change design and specifications without notice.