

# LED Panel Light

## Model Number:

CPS-PL-2X2-40W-UL-40  
CPS-PL-2X2-40W-UL-50

## Performance Summary

- ⊙ Size/Power: 2x2' (40W)
- ⊙ Luminosity Efficacy: >110lm/w, 80% saving in comparison to conventional lights
- ⊙ Color Temperature: 4000K, 5000K
- ⊙ Thickness: 10mm (2/5")
- ⊙ LED mounted at side
- ⊙ UL/cUL, DLC Certified
- ⊙ Warranty: 5 years
- ⊙ L70 Life: > 50,000 hours



## Ordering Information

Item No.	Description	Dimmable (Yes or No)	LED Type	LED Q'ty	Power (W)	Lumen (LM)	L70 Life	Certificate
CPS-PL-2X2-40W	2x 2' LED panel light DLC listed	No	SMD2835	264	40	4400	>50,000 hrs	UL/cUL,DLC

40-4000K,50-5000K.

## Dimension/Weight

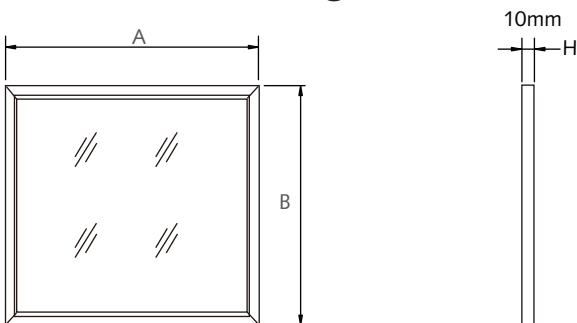

Size	Dimension (A x B mm)	Weight
2X2'	603x603	5.5kg (12 lbs)

## Features

- ⊙ Luminosity Efficacy: >110lm/w
- ⊙ Voltage input: 100~277V ac
- ⊙ LED chips: SMD 2835
- ⊙ Color Temperature: 4000K, 5000KCRI:
- ⊙ Ra>80
- ⊙ Beam Angle: 150 degree
- ⊙ Application: indoor only
- ⊙ Installation: Suspension, Wall Mount, Recessed, Ceiling Mount
- ⊙ Warranty: 5 years
- ⊙ Certificate: UL/cUL,DLC

## Lux Chart

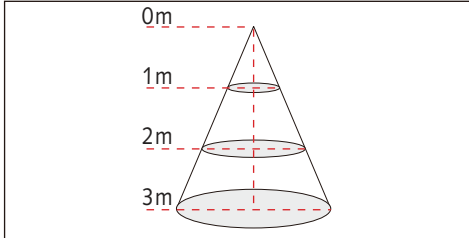

Size	Wattage	Lux		
		A	B	C
2X2'	40W	350	160	70

## Photometrics

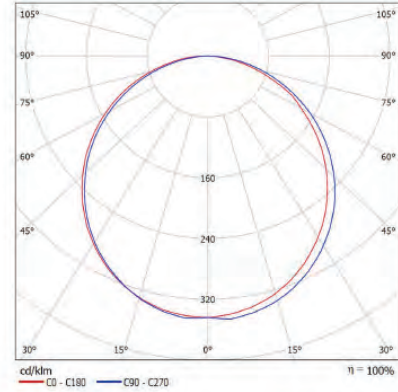

## Installation

### Earthquake Clips Use

1. Remove the ceiling tile at an appropriate location where the product is to be installed, and raise the product above the bar.
2. Place one end of the product on the T-bar. To secure the luminaire (fixture) position in ceiling, squeeze tabs into T-bars to lock luminaire (fixture).
3. With power turned off at the breaker, connect power leads to driver according to wiring diagram.

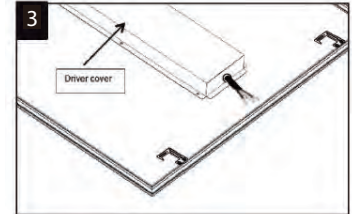
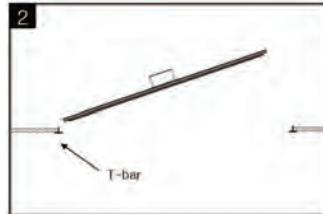
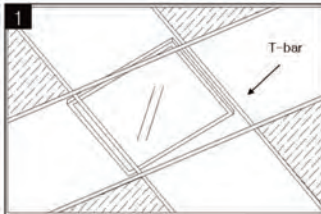

4. Use the protective brackets for safety. After securing the product on the T-bar, secure panel to the ceiling with aircraft cable or wires capable of supporting 100 lbs minimum.

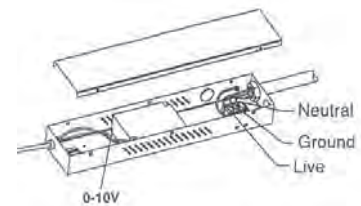
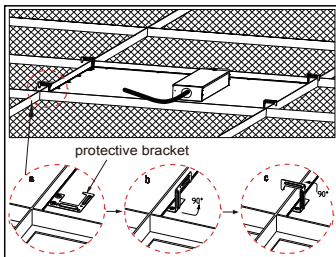

### Wall Mount

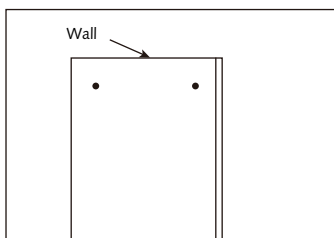

1. Nailing two plastic expansion screws and other screws into the wall according to the size shown in the illustration

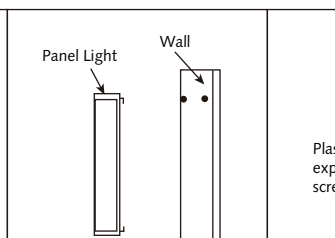

2. Hanging the panel on the finished screws

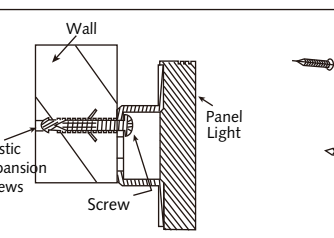

3. This is the combining drawing for wall and panel, please make the installation according to the installation drawing.

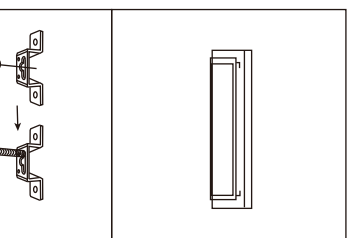

4. Installation finished

### Recessed Mount

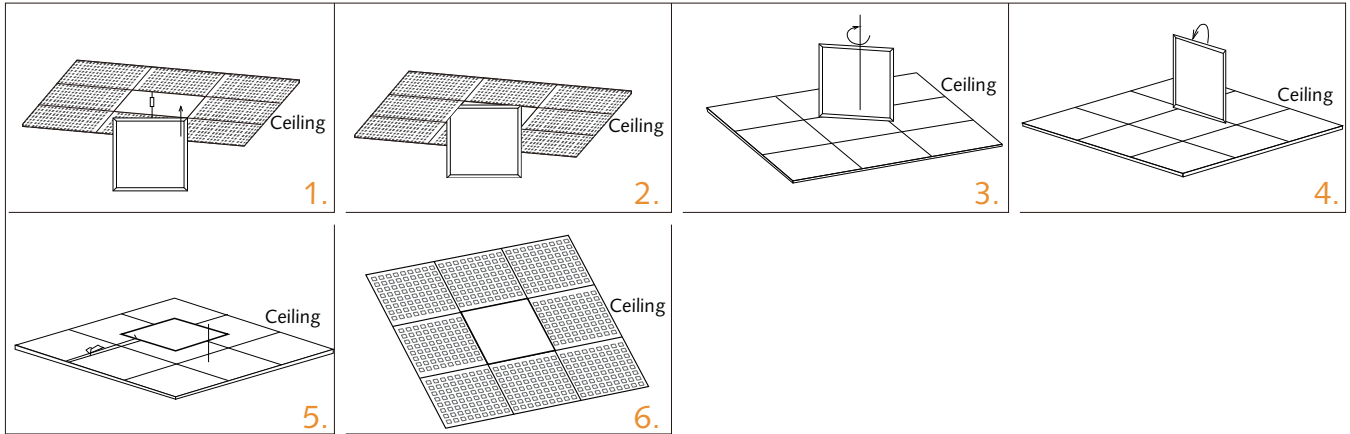

### Suspension

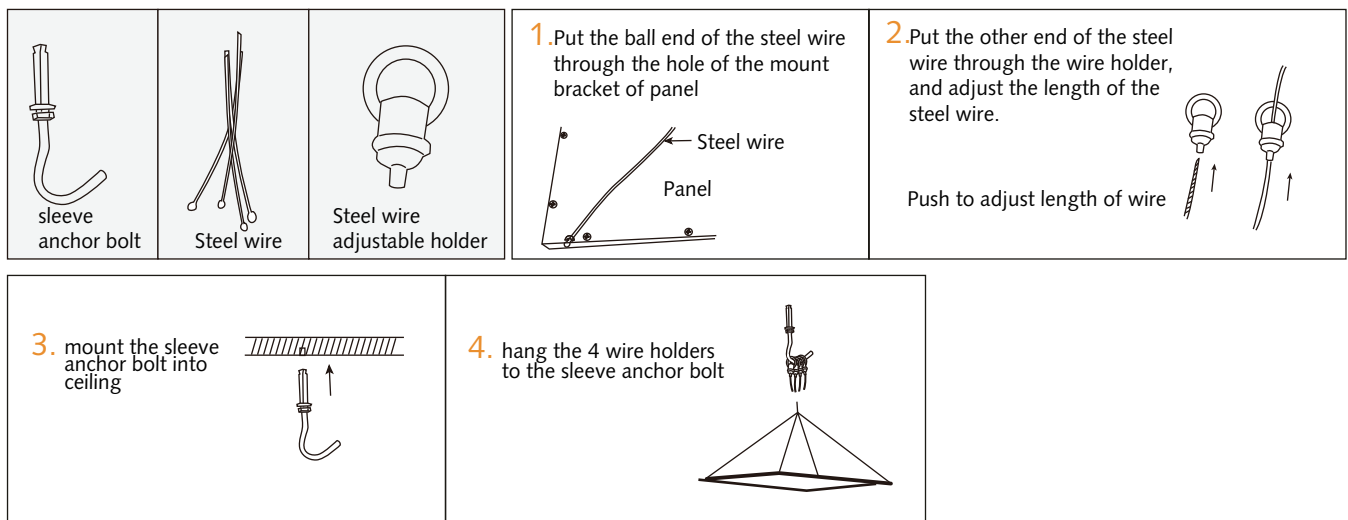

### Ceiling Mount

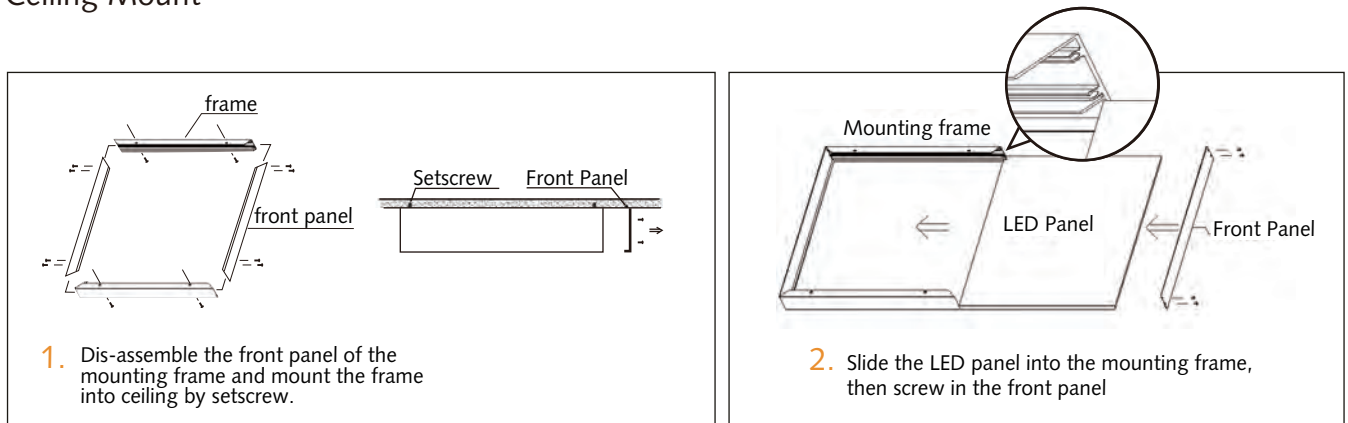

## Wiring Diagram (0-10V Dimmable Panel)

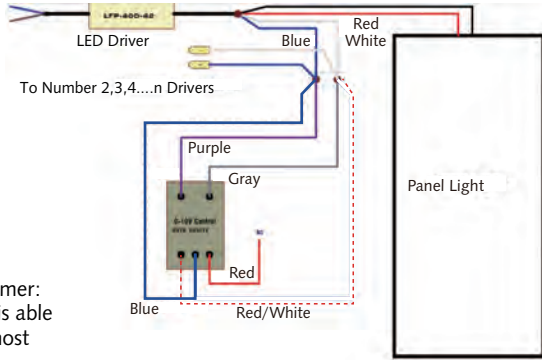

Dimmer Recommended  
Lutron LED 0~10V dimmer:  
DVTV, DVSCVT which is able  
to be purchased from most  
of electricity stores

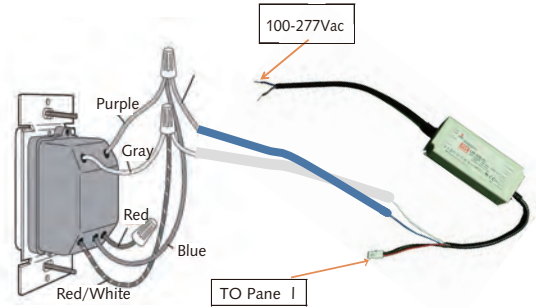

## Packaging

Size	Carton Size (mm)	G.W/Carton	Quantity
2X2'	655x655x115	14KG	2

