

LED Panel Light

Model Number:

CPS-PL-2X4-50W-UL-40
CPS-PL-2X4-50W-UL-50

Performance Summary

- ⊙ Size/Power: 2x4'(50W)
- ⊙ Luminosity Efficacy: >110lm/w, 80% saving in comparison to conventional lights
- ⊙ Color Temperature: 4000K, 5000K
- ⊙ Thickness: 10mm (2/5")
- ⊙ LED mounted at side
- ⊙ UL/cUL, DLC Certified
- ⊙ Warranty: 5 years
- ⊙ L70 Life: > 50,000 hours

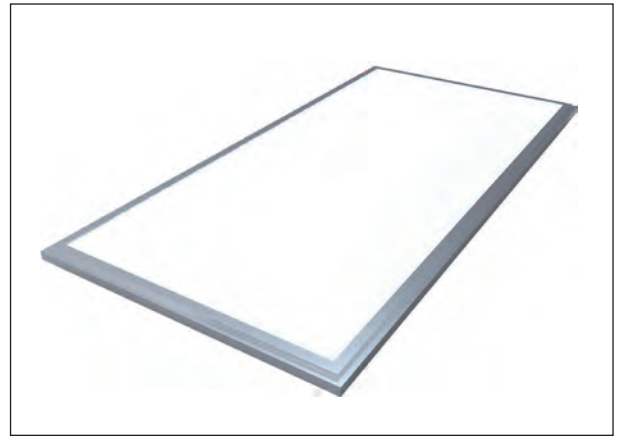

Ordering Information

Item No.	Description	Dimmable (Yes or No)	LED Type	LED Q'ty	Power (W)	Lumen (LM)	Certificate
CPS-PL-2X4-50W-UL-40 CPS-PL-2X4-50W-UL-50	2 x 4' LED panel light DLC listed	Yes	SMD2835	280	50	5500	UL/cUL,DLC

Dimension/Weight

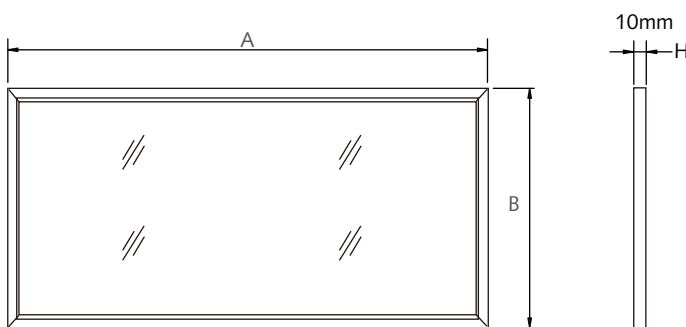

Size	Dimension (A x B mm)	Weight
2X4'	1210x603	11kg (24 lbs)

Features

- ⊙ Luminosity Efficacy: >110lm/w
- ⊙ Voltage input: 100~277V ac
- ⊙ LED chips: SMD 2835
- ⊙ Color Temperature: 3000K, 4000K, 5000K
- ⊙ CRI: Ra>80
- ⊙ Beam Angle: 150 degree
- ⊙ Application: Indoor only
- ⊙ Installation: Suspension, Wall Mount, Recessed, Ceiling Mount
- ⊙ Warranty: 5 years
- ⊙ Certificate: UL/cU,DLC

Lux Chart

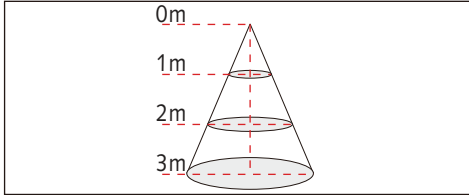

Size	Wattage	Lux		
		1m	2m	3m
2X4'	50W	440	200	80
2X4'	75W	660	300	120

Photometrics

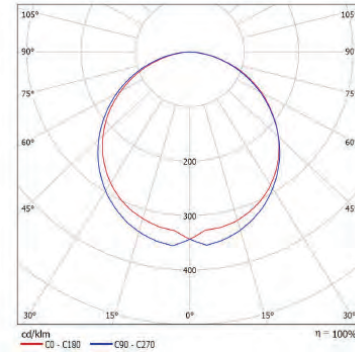

Installation

Earthquake Clips Use

1. Remove the ceiling tile at an appropriate location where the product is to be installed, and raise the product above the bar.
2. Place one end of the product on the T-bar. To secure the luminaire (fixture) position in ceiling, squeeze tabs into T-bars to lock luminaire (fixture).
3. With power turned off at the breaker, connect power leads to driver according to wiring diagram.

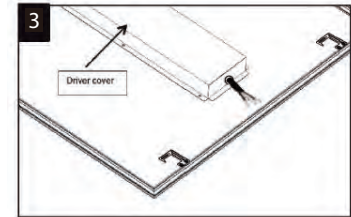
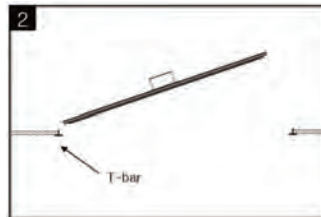
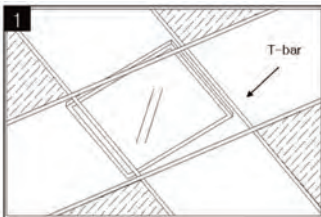

4. Use the protective brackets for safety. After securing the product on the T-bar, secure panel to the ceiling with aircraft cable or wires capable of supporting 100 lbs minimum.

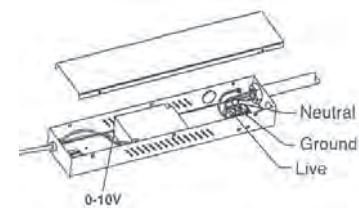
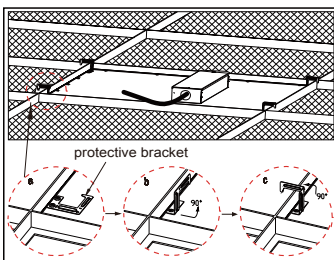

Wall Mount

1. Nailing two plastic expansion screws and other screws into the wall according to the size shown in the illustration

2. Hanging the panel on the finished screws

3. This is the combining drawing for wall and panel, please make the installation according to the installation drawing.

4. Installation finished

Recessed Mount

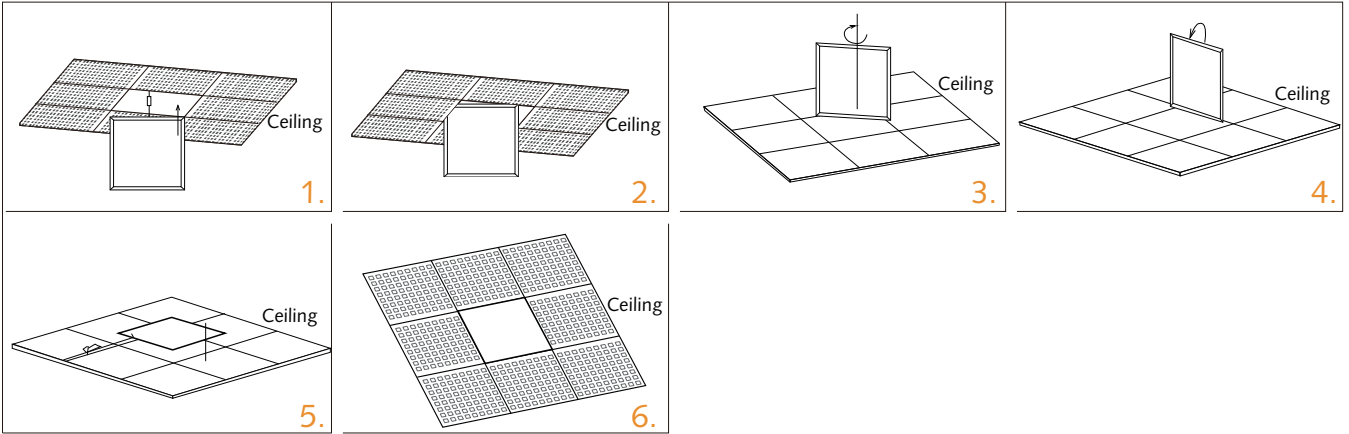

Suspension

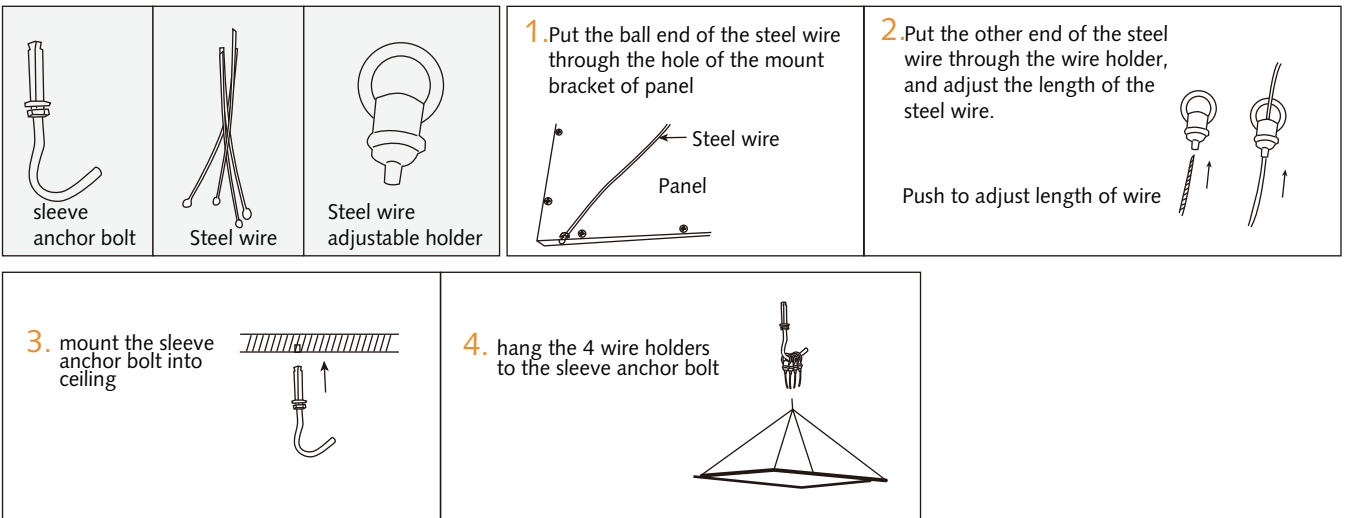

Ceiling Mount

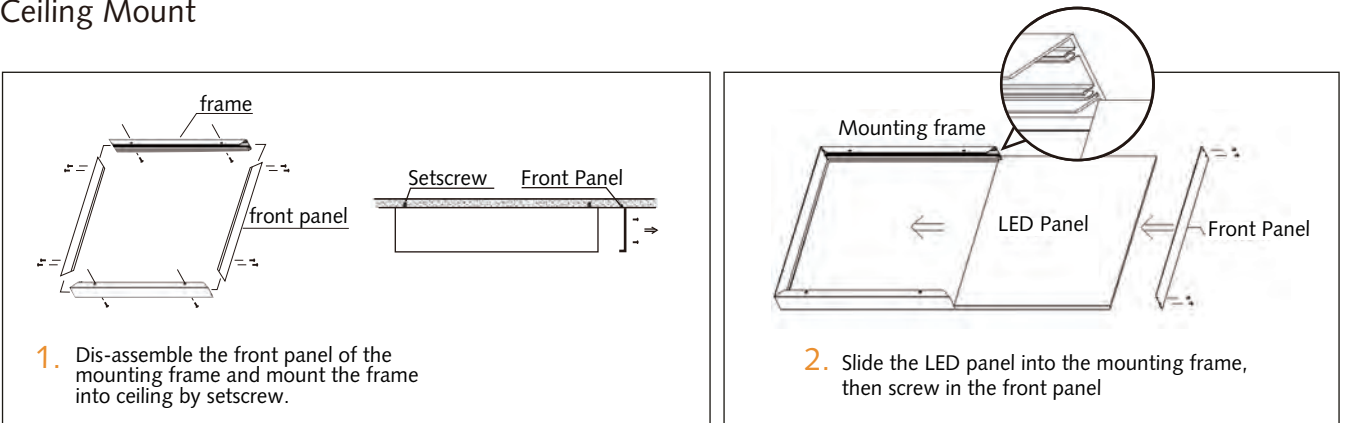

Wiring Diagram (0-10V Dimmable Panel)

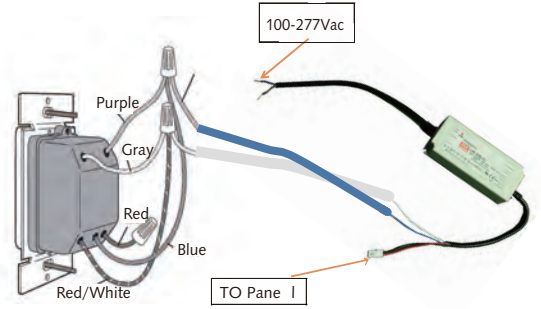
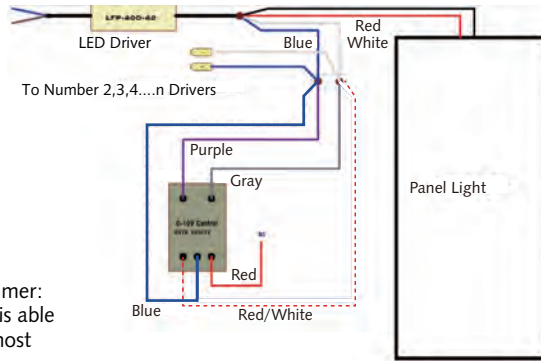

Dimmer Recommended
Lutron LED 0~10V dimmer:
DVTV, DVSCVT which is able
to be purchased from most
of electricity stores

Packaging

Size	Carton Size (mm)	G.W/Carton	Quantity
2X4'	1275x665x120	19KG	2

