



www.phd-mfg.com

# BEAM CLAMPS

**FIG. 7001 & 7002**  
HEAVY DUTY BEAM CLAMP

Note: Set screw included.

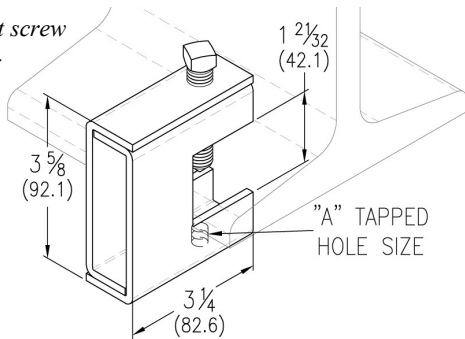

Fig. No.	A	Material Thickness	Set Screw	Max. Rec. Load	Wt. Each	
				lbs.	kN	lbs. kg
7001	3/8-16	3/16 (4.76)	1/2 X 2	1300	(5.78)	1.56 (.71)
7002	1/2-13	1/4 (6.35)	1/2 X 2	1900	(8.45)	2.01 (.91)

For beam flanges between 3/4" (19.05) & 1 5/8" (41.28) thick

**FIG. 7005 - 7007**  
BEAM CLAMP

Material: Malleable iron.

Note: Not available in Stainless Steel. Set screw included.

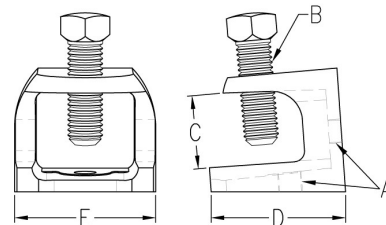

Fig. No.	A	B	C	D	E
7005	1/4-20	5/16-18	7/8	(22.23)	1 3/8 (34.93)
7006	3/8-16	1/2-13	1 1/8	(28.58)	1 13/16 (46.04)
7007	1/2-13	1/2-13	1 1/4	(31.75)	2 5/16 (58.74)

Fig. No.	Max. Flange Thickness	Max. Rec. Load		Wt. Each	
		lbs.	kN	lbs.	kg
7005	3/4	(19.05)	150	(0.67)	.20 (.09)
7006	3/4	(19.05)	350	(1.56)	.60 (.27)
7007	1	(25.4)	1000	(4.45)	1.05 (.48)

**FIG. 7011 - 7020**  
"I" BEAM CLAMP

Note: Set screw included.

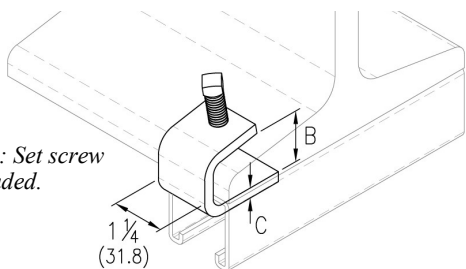

Fig. No.	Set Screw	B	C	Max. Rec. Load		Wt. Each	
				lbs.	kN	lbs.	kg
7011	3/8-16	1 1/8 (28.58)	1/4 (6.35)	900*	(4.00)	.26 (.12)	
7012	1/2-13	1 1/8 (28.58)	3/8 (9.53)	1800*	(8.00)	.64 (.29)	
7020	1/2-13	2 (50.8)	3/8 (9.53)	900*	(4.00)	.72 (.33)	

\* Max loads when used in pairs.

**FIG. 7025**  
"I" BEAM CLAMP

Note: Set screw included.

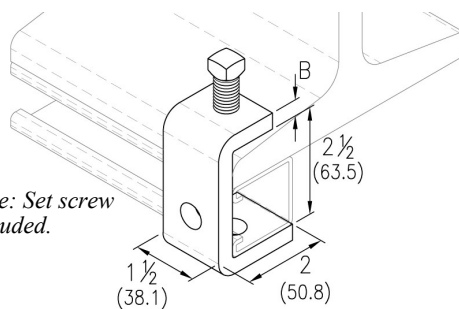
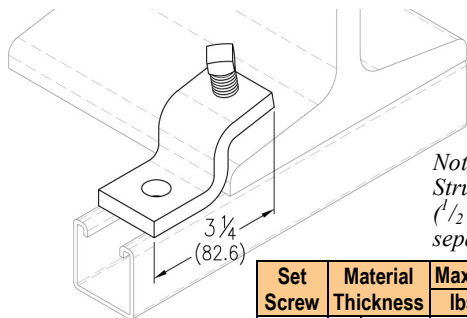

Fig. No.	Set Screw	Material Thickness	Max. Rec. Load		Wt. Each	
			lbs.	kN	lbs.	kg
7025	1/2-13	3/8 (9.53)	1000*	(4.45)	.94 (.43)	

\* Max loads when used in pairs.

**FIG. 7030**  
"Z" BEAM CLAMP

Note: Set screw included. Strut nut and hex bolt (1/2"-13 x 1 3/4") sold separately.



Set Screw	Material Thickness	Max. Rec. Load	Wt. Each	
		lbs.	kN	lbs. kg
1/2-13	3/8 (9.53)	900*	(4.00)	.63 (.29)

\* Max loads when used in pairs.

**FIG. 7040**  
BEAM CLAMP

Note: Strut nut and hex bolt (1/2"-13 x 1 3/4") sold separately.

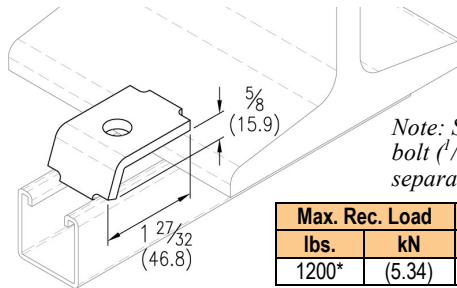

Max. Rec. Load		Wt. Each	
lbs.	kN	lbs.	kg
1200*	(5.34)	.26	(.12)

\* Max loads when used in pairs.

Standard Product Information for 1 5/8" (41.3) width series channel fittings (Unless Otherwise Noted)

Hole Diameter: 9/16" (14.3); Hole Spacing-From End: 1 3/16" (20.6); Hole Spacing-On Center: 1 7/8" (47.6); Width: 1 5/8" (41.3); Thickness: 1/4" (6.4)  
Material: Carbon steel (Type 304 or 316 Stainless Steel upon request); Finish: Electro-galvanized (hot-dip galvanized, e-coat, and powder coated upon request)  
Ordering: Specify figure number, material, and finish.

Unless otherwise specified, all dimensions on drawings and in charts are in inches and dimensions shown in parentheses are in millimeters.

# BEAM CLAMPS



## FIG. 7050 & 7051

SQUARE U-BOLT

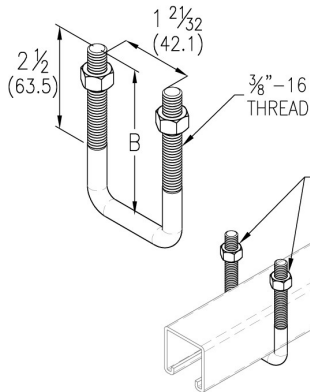

Fig. No.	B	Wt. Each	
		lbs.	kg
7050	3 3/8 (85.73)	.25	(.11)
7051	5 (127.00)	.33	(.15)

INCLUDES HEX NUTS

Note: Not available in Stainless Steel.

## FIG. 7060

BEAM CLAMP FOR USE WITH 1 5/8" STRUT

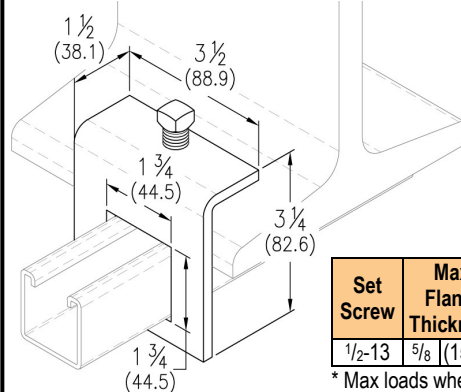

Note: Not available in Stainless Steel.

Set Screw	Max. Flange Thickness	Max. Rec. Load		Wt. Each	
		lbs.	kN	lbs.	kg
1/2-13	5/8 (15.88)	900*	(4.00)	1.07	(.49)

\* Max loads when used in pairs.

## FIG. 7070 - 7076

BEAM CLAMP

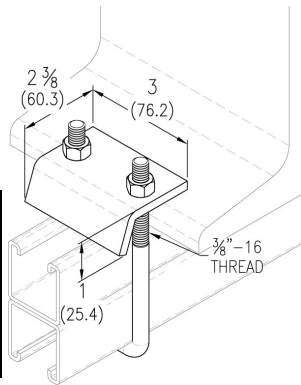

Fig. No.	For Use With
7070	1 5/8" Strut
7075	3 1/4" Strut
7076	1500A or 1600A Series Strut

Fig. No.	Max. Flange Thickness	Max. Rec. Load		Wt. Each	
		lbs.	kN	lbs.	kg
7070	3/4 (19.05)	1200*	(5.34)	.80	(.36)
7075	3/4 (19.05)	1200*	(5.34)	.88	(.40)
7076	3/4 (19.05)	1200*	(5.34)	1.12	(.51)

\* Max loads when used in pairs.

## FIG. 7080 - 7089

BEAM CLAMP

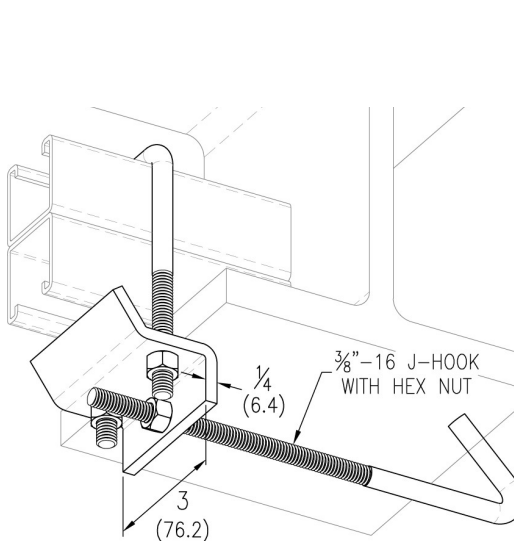

Fig. No.	For Flange Width		Wt. Each	
	lbs.	kg	lbs.	kg
7080	4" - 5 7/8"	(101.6 - 149.2)	1.42	(0.64)
7081	6" - 8 7/8"	(152.4 - 225.4)	1.51	(0.69)
7082	9" - 11 7/8"	(228.6 - 301.6)	1.60	(0.73)
7083	12" - 14 7/8"	(304.8 - 377.8)	1.70	(0.77)
7084	15" - 17 7/8"	(381.0 - 454.0)	1.79	(0.81)
7085	4" - 5 7/8"	(101.6 - 149.2)	1.51	(0.69)
7086	6" - 8 7/8"	(152.4 - 225.4)	1.57	(0.71)
7087	9" - 11 7/8"	(228.6 - 301.6)	1.66	(0.75)
7088	12" - 14 7/8"	(304.8 - 377.8)	1.76	(0.80)
7089	15" - 17 7/8"	(381.0 - 454.0)	1.85	(0.84)

Note: 1" (25.4) Max. Flange Thickness  
Torque J-Hook nut to 60 in./lbs  
Torque U-Bolt nuts to 150 in./lbs.

Fig. No.	For Use With
7080 - 7084	1 5/8" Strut
7085 - 7089	3 1/4" Strut

## FIG. 7090 - 7099

BEAM CLAMP

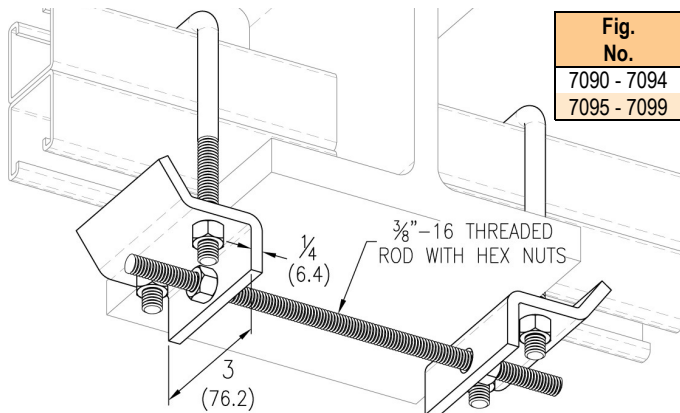

Fig. No.	For Use With
7090 - 7094	1 5/8" Strut
7095 - 7099	3 1/4" Strut

Fig. No.	For Flange Width		Wt. Each	
	lbs.	kg	lbs.	kg
7090	4" - 5 7/8"	(101.6 - 149.2)	2.82	(1.28)
7091	6" - 8 7/8"	(152.4 - 225.4)	2.89	(1.31)
7092	9" - 11 7/8"	(228.6 - 301.6)	2.96	(1.34)
7093	12" - 14 7/8"	(304.8 - 377.8)	3.04	(1.38)
7094	15" - 17 7/8"	(381.0 - 454.0)	3.11	(1.41)
7095	4" - 5 7/8"	(101.6 - 149.2)	3.00	(1.36)
7096	6" - 8 7/8"	(152.4 - 225.4)	3.07	(1.39)
7097	9" - 11 7/8"	(228.6 - 301.6)	3.14	(1.42)
7098	12" - 14 7/8"	(304.8 - 377.8)	3.22	(1.46)
7099	15" - 17 7/8"	(381.0 - 454.0)	3.29	(1.49)

Note: 1" (25.4) Max. Flange Thickness  
Torque U-Bolt nuts to 150 in./lbs.

Torque all-thread rod connector nuts to 60 in./lbs.

### Standard Product Information for 1 5/8" (41.3) width series channel fittings (Unless Otherwise Noted)

Hole Diameter: 9/16" (14.3); Hole Spacing-From End: 1 1/16" (20.6); Hole Spacing-On Center: 1 7/8" (47.6); Width: 1 5/8" (41.3); Thickness: 1/4" (6.4)  
Material: Carbon steel (Type 304 or 316 Stainless Steel upon request); Finish: Electro-galvanized (hot-dip galvanized, e-coat, and powder coated upon request)  
Ordering: Specify figure number, material, and finish.

Unless otherwise specified, all dimensions on drawings and in charts are in inches and dimensions shown in parentheses are in millimeters.