

SPECIFICATION & FEATURES

DESCRIPTION:

Orbit Industries' insulated set-screw steel EMT connectors are used in dry locations to bond EMT thinwall conduits to electrical junction boxes or enclosures. The steel construction ensures mechanical protection to the conduit and designated electrical junction box or enclosure.

STEEL INSULATED EMT
CONNECTORS SET-SCREW TYPE
1/2" ~ 1"



CERTIFICATION:

UL file E310660, conforms to UL 514B

FEATURES:

- Steel
- Zinc Electro-Plated
- Concrete- Tight when Taped
- Suitable for applications above 600V
- Sizes 2-1/2" to 4" are also listed for RIGID and IMC Conduits
- With Insulated Throat (Yellow, Throat Color may vary)

LINE DRAWINGS:

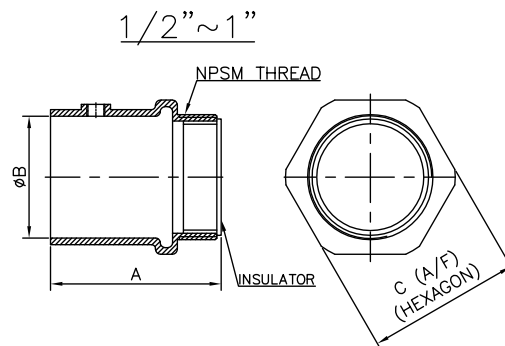

CONFIGURATION DATA:

Part No.	Trade Size	A (in)	B (in)	C (in)	Screw Size	Std.Pkg.	Master Ctn.
OF7701-S	1/2"	1.370	0.724	0.965	12-24 UNC X 0.3in FHCP	50	500
OF7702-S	3/4"	1.654	0.941	1.201	12-24 UNC X 0.3in FHCP	25	250
OF7703-S	1"	2.059	1.181	1.465	12-24 UNC X 0.3in FHCP	10	100



SPECIFICATION & FEATURES

DESCRIPTION:

Orbit Industries' insulated set-screw steel EMT connectors are used in dry locations to bond EMT thinwall conduits to electrical junction boxes or enclosures. The steel construction ensures mechanical protection to the conduit and designated electrical junction box or enclosure.

STEEL INSULATED EMT CONNECTORS SET-SCREW TYPE 1-1/4" ~ 2"



CERTIFICATION:

UL file E310660, conforms to UL 514B



FEATURES:

- Steel
- Zinc Electro- Plated
- Concrete- Tight when Taped
- Suitable for applications above 600V
- Sizes 2-1/2" to 4" are also listed for RIGID and IMC Conduits
- With Insulated Throat (Yellow, Throat color may vary)

LINE DRAWINGS:

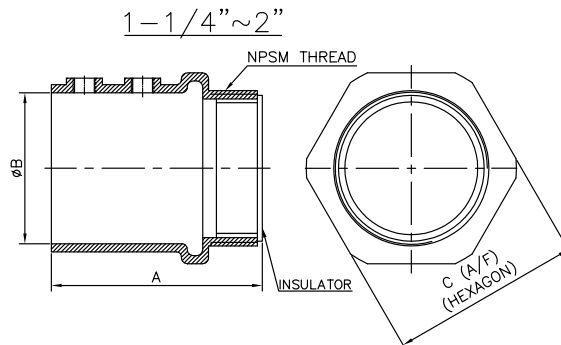

CONFIGURATION DATA:

Part No.	Trade Size	A (in)	B (in)	C (in)	Screw Size	Std.Pkg.	Master Ctn.
OF7704-S	1-1/4"	2.453	1.531	1.823	1/4"- 20UNC X 0.41in FHCP	10	100
OF7705-S	1-1/2"	2.610	1.768	2.075	1/4"- 20UNC X 0.41in FHCP	10	50
OF7706-S	2"	2.984	2.224	2.559	1/4"- 20UNC X 0.41in FHCP	5	50



SPECIFICATION & FEATURES

DESCRIPTION:

Orbit Industries' insulated set-screw steel EMT connectors are used in dry locations to bond EMT thinwall conduits to electrical junction boxes or enclosures. The steel construction ensures mechanical protection to the conduit and designated electrical junction box or enclosure.

STEEL INSULATED EMT CONNECTORS SET-SCREW TYPE 2-1/2" ~ 4"



CERTIFICATION:

UL file E310658, conforms to UL 514B

FEATURES:

- Steel
- Zinc Electro-Plated
- Concrete-Tight when Taped
- Suitable for applications above 600V
- Sizes 2-1/2" to 4" are also listed for RIGID and IMC Conduits
- With Insulated Throat (Yellow, Throat color may vary)

LINE DRAWINGS:

2-1/2" ~ 4"

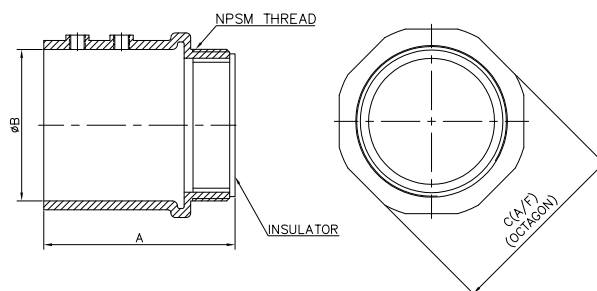

CONFIGURATION DATA:

Part No.	Trade Size	A (in)	B (in)	C (in)	Screw Size	Std.Pkg.
OF7707-S	2-1/2"	3.228	2.921	3.327	1/4"-28 UNF X 0.41in FHCP OR 1/4"-20 UNC X 0.41in FHCP	12
OF7708-S	3"	3.425	3.547	3.886	1/4"-28 UNF X 0.41in FHCP OR 1/4"-20 UNC X 0.41in FHCP	12
OF7709-S	3-1/2"	3.740	4.047	4.370	1/4"-28 UNF X 0.41in FHCP OR 1/4"-20 UNC X 0.41in FHCP	6
OF7710-S	4"	3.937	4.547	4.941	1/4"-28 UNF X 0.41in FHCP OR 1/4"-20 UNC X 0.41in FHCP	6

