

Industrial LED luminaires
Exit and Emergency

Sure-Lites



SEL/SELM Indoor

WAREHOUSE / DISTRIBUTION | MANUFACTURING | GYMNASIUMS / MULTI-PURPOSE ROOMS / ATHLETIC CENTER | BIG BOX / RETAIL

SEL



Polycarbonate

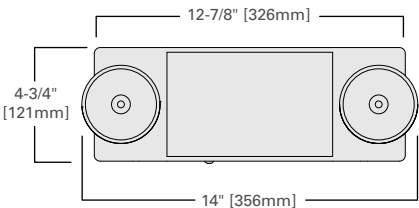

SELM



Metal

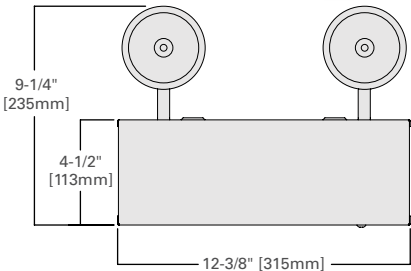

Feature	Benefit
Up to 60 feet of egress coverage	Up to \$300 savings on installation
LED source with Nickel cadmium battery	Up to ten years with no maintenance
Optional remote capacity	Indoor, outdoor design flexibility
Self diagnostics w/laser test	Reduce labor of NFPA/OSHA testing

Certification/warranty
UL924 damp location
NFPA 101 compliant
NEC/OSHA compliant
5-year product warranty
7-year prorated battery warranty

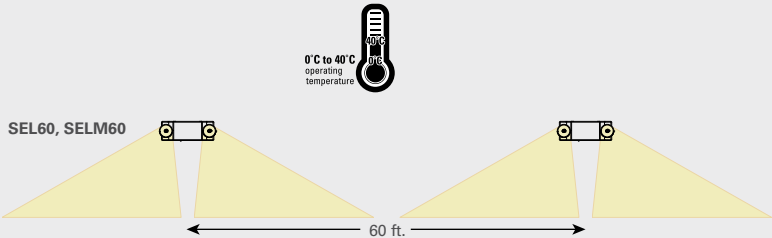

SELW/SELD Outdoor

WAREHOUSE / DISTRIBUTION | MANUFACTURING | GYMNASIUMS / MULTI-PURPOSE ROOMS / ATHLETIC CENTER | BIG BOX / RETAIL

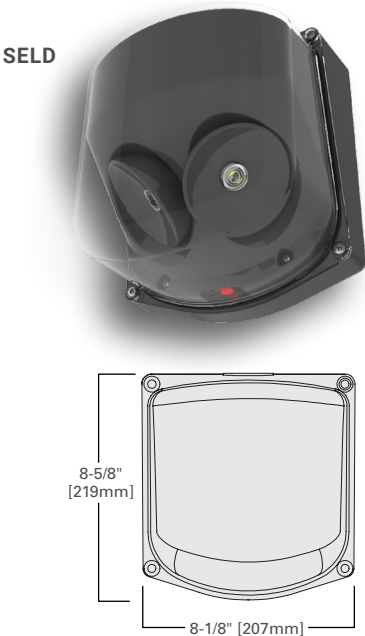
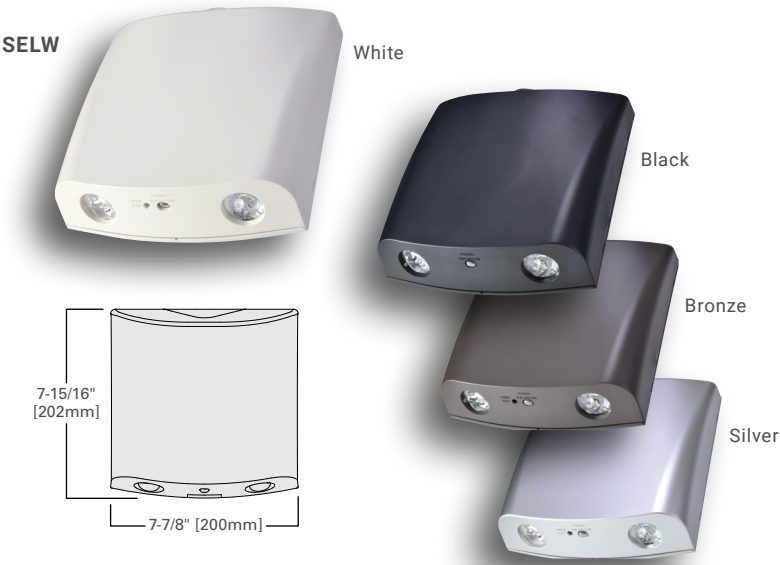

Feature	Benefit
LED source with Nickel cadmium battery	Up to ten years with no maintenance
Forward throw optic	Maximum design flexibility
29 feet spacing	Less fixtures required
Self diagnostics w/laser test	Reduce labor of NFPA/OSHA testing

Certification/warranty
UL924 wet location
NFPA 101 compliant
NEC/OSHA compliant
5-year product warranty
7-year prorated battery warranty

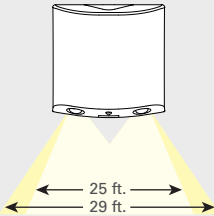

Feature	Benefit
LED source with Nickel cadmium battery	Up to ten years with no maintenance
58 foot spacing	Less fixtures required
Standard Self diagnostics with laser test	Reduce labor of NFPA/ OSHA testing
NEMA 4X; IP66; - 30° C to 50° C	Maximum design flexibility

Certification
UL924 wet location
NEMA 4X
NFPA 101 compliant
NEC/OSHA compliant
IP66
NSF
IP66HAZ (class 1, Div 2) option

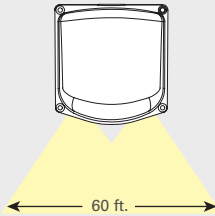

LPX Exit

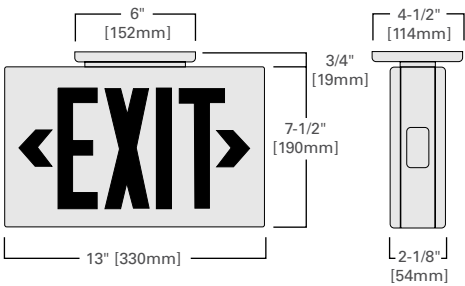

Feature	Benefit
LED source with Nickel cadmium battery	Up to ten years with no maintenance
Field adjustable for red or green	Maximum design flexibility
Optional emergency heads or remote capacity	Less fixtures required
Standard Self diagnostics with laser test	Reduce labor of NFPA/OSHA testing

Certification/warranty
UL924 damp location
NFPA 101 compliant
NEC/OSHA compliant
5-year product warranty
7-year prorated battery warranty



LPX LED Combo

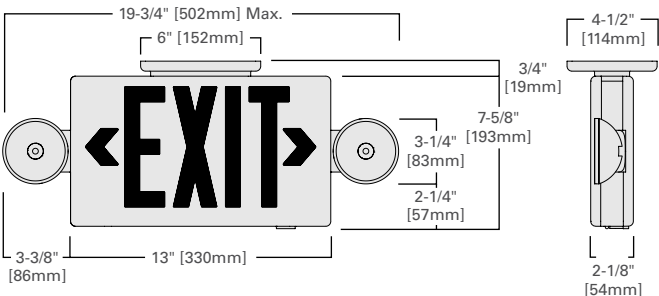

WAREHOUSE / DISTRIBUTION | MANUFACTURING | GYMNASIUMS / MULTI-PURPOSE ROOMS / ATHLETIC CENTER | BIG BOX / RETAIL

UX Exit

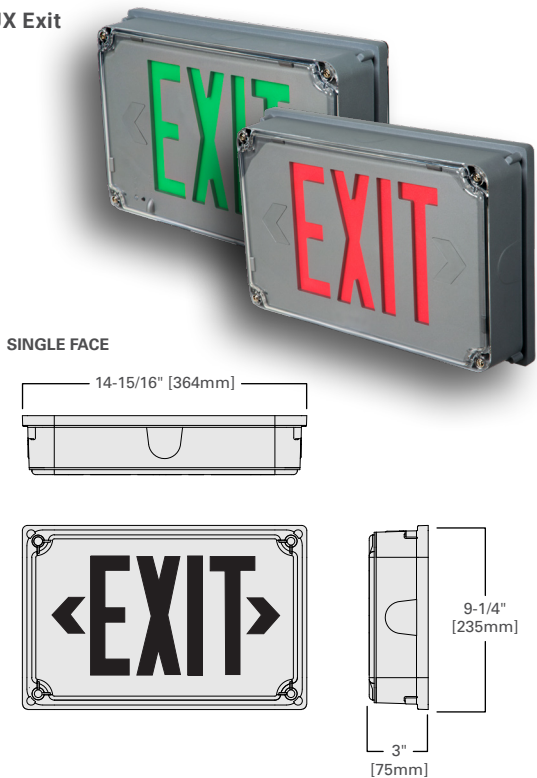

LPWX Exit

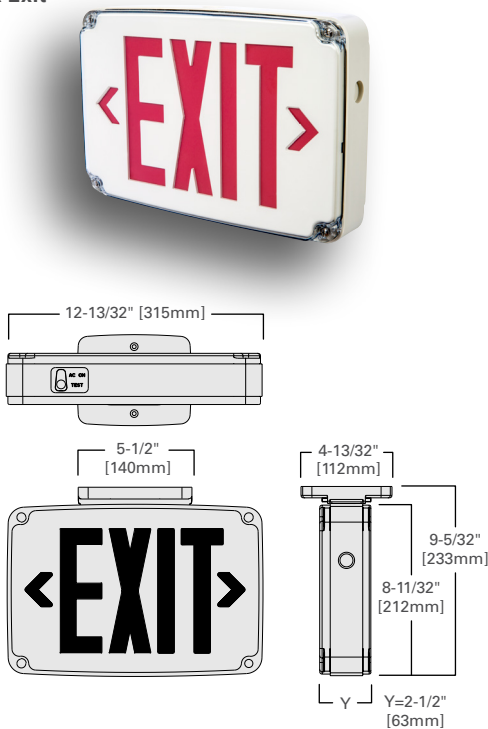

Feature	Benefit
LED source with Nickel cadmium battery	Up to ten years with no maintenance
Field adjustable for red or green	Maximum design flexibility
Standard Self diagnostics with laser test	Reduce labor of NFPA/OSHA testing
NEMA 4X; IP66; - 30° C to 50° C	Maximum design flexibility

Certification/warranty
UL924 wet location
NEMA 4X/IP66
NFPA 101 compliant
NEC/OSHA/NSF compliant
HAZ (class 1, Div 2) rated option
NSF
5-year product warranty, 7-year prorated battery warranty



Feature	Benefit
LED source with Nickel cadmium battery	Up to ten years with no maintenance
UV stabilized polycarbonate housing	Outdoor capable
Standard Self diagnostics with laser test	Reduce labor of NFPA/OSHA testing
Wet location listed; - 30° C to 50° C	Maximum design flexibility

Certification/warranty
UL924 wet location
NFPA 101 compliant
NEC/OSHA compliant
5-year product warranty, 7-year prorated battery warranty



Lighting Brands

Ametrix
AtLite
Corelite
Ephesus
Fail-Safe
Halo
Halo Commercial
Invue
io
Iris
Lumark
Lumière
McGraw-Edison
Metalux
MWS
Neo-Ray
Portfolio
RSA
Shaper
Streetworks
Sure-Lites

Controls Brands

Greengate
Fifth Light

Connected Lighting Systems

HALO Home
WaveLinx

IoT Platform

Trellix



Cooper Lighting Solutions
1121 Highway 74 South
Peachtree City, GA 30269
P: 770-486-4800
www.cooperlighting.com

Canada Sales
5925 McLaughlin Road
Mississauga, Ontario L5R 1B8
P: 905-501-3000
F: 905-501-3172

Cooper Lighting Solutions is a registered trademark.

All other trademarks are property of their respective owners.

Product availability, specifications, and compliances are subject to change without notice.

© 2020 Cooper Lighting Solutions
All Rights Reserved
Printed in USA
Publication No. BR505013EN
January 28, 2021 3:13 PM