

# SPECIFICATION & FEATURES

# NEMA TYPE 1 SCREW COVER ENCLOSURES WITHOUT K.O.

## DESCRIPTION:

Orbit Industries' NEMA Type 1 Enclosures with screw cover are suited for a variety of electrical applications and protect against dust, light, and indirect splashing. This heavy duty box is made with 16 Gauge Steel with wall mounting holes on the back. Boxes are finished with ANSI 61 gray polyester powder paint and meet UL standards.

## CERTIFICATION:

UL file E331152,  
conforms to UL 50 and UL 50E

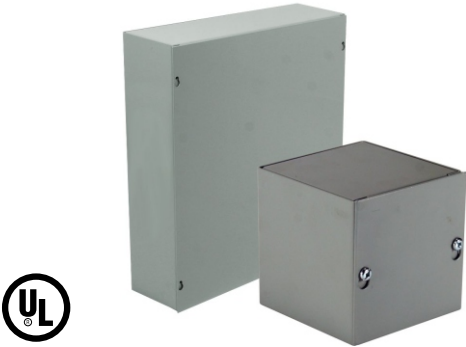

## FEATURES:

- ANSI 61 Gray Polyester Powder Paint Finish inside and out
- 16 Gauge Steel or Plated Steel
- Mounting holes on back of box
- Without Knock out

## KNOCK OUT PATTERNS:

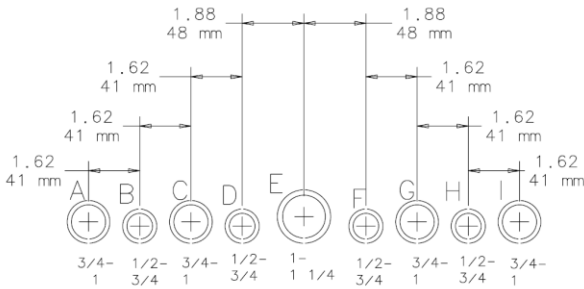

## CONFIGURATION DATA:

Part No.	Enclosure Size (in)			Std.Pkg.
	Width (in)	Height (in)	Depth (in)	
444NK	4	4	4	6
464NK	4	6	4	6
664NK	6	6	4	6
666NK	6	6	6	6
884NK	8	8	4	6
886NK	8	8	6	4
10104NK	10	10	4	4
10106NK	10	10	6	4
12124NK	12	12	4	2
12126NK	12	12	6	2
12128NK	12	12	8	1
12186NK	12	18	6	1
16164NK	16	16	4	1
16166NK	16	16	6	1
16168NK	16	16	8	1
18184NK	18	18	4	1
18186NK	18	18	6	1
18188NK	18	18	8	1
24244NK	24	24	4	1
24246NK	24	24	6	1
24248NK	24	24	8	1

[www.orbitelectric.com](http://www.orbitelectric.com)

Application and Performance Specification Information is Subject to Change Without Notification

LOS ANGELES, CA 1-800-90-ORBIT

