



**Product Datasheet**

**ANDERSON FARGO**

**VHCL40516B -- Terminal, Compression**



Copper Compression Terminal lug (Long Barrel)

**Product Specifications**

|  |   |
|--|---|
| <p>Series Image (Lugs)</p>                           |  <p><b>VHCL Series</b><br/>Copper Compression Lug<br/>Long Barrel 1 or 2 hole<br/>Tin Plated - UL Listed<br/>VERSAtile (die and VC tools)</p> |
| <b>Material</b>                                      | Copper  |
| <b>PDF Catalog Page</b>                              | <a href="#">Click HERE to view the web page.</a>  |
| <b>Plating</b>                                       | Yes   |
| <b>Inhibitor</b>                                     | No  |
| <b>Number of Pad Holes</b>                           | 2   |
| <b>Pad Bolt Diameter</b>                             | 0.31 in (7.87 mm)   |
| <b>VersaCrimp Conductor Size Minimum</b>             | .328 in   |
| <b>VersaCrimp Conductor Size Maximum</b>             | .528 in   |
| <b>Die Type Tooling Crimp Conductor Size Minimum</b> | .522 in   |
| <b>Die Type Tooling Conductor Size Maximum</b>       | .528 in   |
| <b>Lug Conductor Type</b>                            | CU  |
| <b>Spade Holes</b>                                   | 2   |
| <b>Bolt Diameter</b>                                 | 0.31 in (7.87 mm)   |
| <b>Crimp Method</b>                                  | VERSAtile (accomodates conventional and Anderson tools)   |
| <b>UL Listed</b>                                     | Yes   |
| <b>Body Material</b>                                 | Copper Tube   |
| <b>Dimension B</b>                                   | 1.62 in (44 mm)   |
| <b>Dimension C</b>                                   | 0.88 in (22 mm)   |
| <b>Dimension L</b>                                   | 4.0 in (101.6 mm)   |
| <b>Dimension T</b>                                   | 0.12 in (3 mm)  |
| <b>Dimension W</b>                                   | 1 in (25.4 mm)  |
| <b>UPC Code</b>                                      | 09635933813   |
| <b>Standard Package</b>                              | 10  |
| <b>Standard Package Unit</b>                         | Each  |
| <b>Min Order Qty</b>                                 | 10  |
| <b>Weight / Ea.</b>                                  | 0.196 lbs   |

Material Type

Non-Standard

### Notes

For use with either VERSA-Crimp or conventional compression tools. For use with copper stranded conductor only. When used with die type compression tools, use with maximum size conductor only Rated at 34.5 KV.

### Features

Color coded bands or easy die selection.

### Compressed Product Number

VHCL40516B

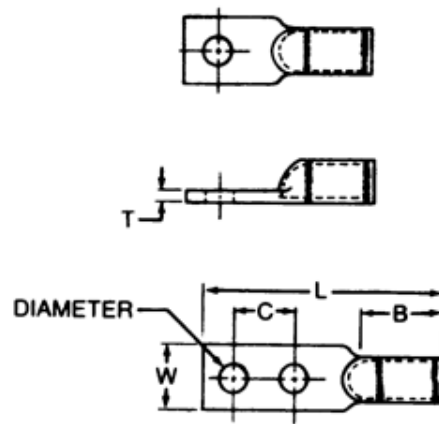

## VHS & VHCL

| Catalog Number<br>VHS<br>VHCL | ANDERSON™ VERSA-CRIMP® COMPRESSION TOOLS<br>(Crimps per Connection) |  |             |            |            |           |                   |                | CONVENTIONAL COMPRESSION DIE TOOLING<br>(Crimps per Connection) |                      |                                   |  |                                   |                                   |                                    |   |              |                     |                       |   |          | Conductor<br>Insulation<br>Strip<br>Lengths<br>(Min.)<br>① |  |
|-------------------------------|---|--|-------------|------------|------------|-----------|-------------------|----------------|---|----------------------|-----------------------------------|--|-----------------------------------|-----------------------------------|------------------------------------|---|--------------|---------------------|-----------------------|---|----------|--|--|
|                               | Y-C Tools<br>Wire Range<br>AWG or MCM<br>Stranded<br>(Copper Only)  | VERSA-CRIMP® Tools<br>(Number of Crimps) |             |            |            |           |                   |                | Copper<br>Wire<br>Size<br>AWG or<br>MCM<br>STR                  | Die<br>Color<br>Code | Burdny<br>(Crimps)                | Burdny Longitudinal Indent<br>(Crimps) |                                   |                                   |                                    |   |              | Kearney<br>(Crimps) |                       | Thomas & Betts<br>(Crimps)                |          |  | Hyd.<br>Tools<br>12, 15<br>20 & 40<br>Ton<br>② |
|                               |   | *VC8<br>-500                             | VC8<br>-350 | VC6<br>③   | VC6<br>FT  | VC7<br>FT | VC8<br>AL<br>NIBS | Tool<br>MY29-3 |   |                      | Tool<br>Y34A<br>Indenter<br>Y34PR | Tool<br>Y34B<br>Indenter<br>Y34PR      | Tool<br>Y44B<br>Indenter<br>Y44PR | Tool<br>Y48B<br>Indenter<br>Y48PR | Tool<br>Y48RB<br>Indenter<br>Y48PR | Tools<br>Y35<br>Y39<br>Y45 <sup>†</sup> | Tools<br>"O" | Tools<br>"WH"       | Tools<br>TBM5<br>TBM8 | Hyd.<br>Tools<br>12, 15<br>20 & 40<br>Ton |          |  |  |
|                               |   | Neat<br>Setting                          | Neat        | Neat       | Neat       | Neat      | Neat              | Die            |   |                      | Die                               | Die                                    | Die                               | Die                               | Die                                | Die                                     | Die          | Die                 | Die                   |   |          |  |  |
| -6                            | #6  | 2  | 2           |            |            |           |                   | #6             | Blue  | #6<br>(1)            | A6CD<br>(1)                       | B6CD<br>(1)                            |                                   |                                   |                                    | U5CRT<br>(2)                            |              |                     | Blue<br>(2)           | 24<br>(1)                                 | 1-1/4"   |  |  |
| -4                            | #4  | 2  | 2           |            |            |           |                   | #4             | Gray  | #4<br>(1)            | A4CD<br>(1)                       | B4CD<br>(1)                            |                                   |                                   |                                    | U4CRT<br>(2)                            | 5/16<br>(5)  | 5/16<br>(2)         | Gray<br>(2)           | 29<br>(1)                                 | 1-1/4"   |  |  |
| -2                            | #6-#2   | 2  |             | 2<br>O'lap | 2<br>O'lap | 2         | 2                 | #2             | Brown   | #2<br>(1)            | A2CD<br>(1)                       | B2CD<br>(1)                            |                                   |                                   |                                    | U2CRT<br>(2)                            | 3/8<br>(5)   | 3/8<br>(2)          | Brown<br>(2)          | 33<br>(1)                                 | 1-3/8"   |  |  |
| -1                            | #6-#1   | 3  | 3           | 2          | 2          | 2         | 2                 | #1             | Green   | #1<br>(1)            | A1CD<br>(1)                       | B1CD<br>(1)                            |                                   |                                   |                                    | U1CRT<br>(1)                            |              |                     | Green<br>(2)          | 37<br>(1)                                 | 1-1/2"   |  |  |
| -1/0                          | #6-1/0  | 3  | 3           | 2          | 2          | 2         | 2                 | 1/0            | Pink  | 1/0<br>(1)           | A25D<br>(1)                       | B25D<br>(1)                            | E25D<br>(1)                       |                                   |                                    | U25RT<br>(2)                            | 1/2<br>(5)   | 1/2<br>(2)          | Pink<br>(2)           | 42H(2)<br>42(1)                           | 1-1/2"   |  |  |
| -2/0                          | #4-2/0  | 3  | 3           | 2          | 2          | 2         | 2                 | 2/0            | Black   | 2/0<br>(1)           | A26D<br>(1)                       | B26D<br>(1)                            | E26D<br>(1)                       |                                   |                                    | U26RT<br>(2)                            | 9/16<br>(5)  | 9/16<br>(3)         | Black<br>(2)          | 45<br>(1)                                 | 1-5/8"   |  |  |
| -3/0                          | #2-3/0  | 3  | 3           | 2          | 2          | 2         | 2                 | 3/0            | Orange  | 3/0<br>(1)           | A27D<br>(1)                       | B27D<br>(1)                            | E27D<br>(1)                       |                                   |                                    | U27RT<br>(2)                            | 9/16<br>(5)  | 9/16<br>(3)         | Orange<br>(2)         | 50<br>(1)                                 | 1-5/8"   |  |  |
| -4/0                          | #1-4/0  | 3  | 3           | 2          | 2          | 2         | 2                 | 4/0            | Purple  | 4/0<br>(1)           | A28D<br>(1)                       | B28D<br>(1)                            | E28D<br>(1)                       | C28D<br>(1)                       | F28D<br>(1)                        | U28RT<br>(2)                            | 5/8-1<br>(5) | 5/8-1<br>(3)        | Purple<br>(2)         | 54<br>(1)                                 | 1-3/4"   |  |  |
| -250                          | 1/0-250   | 3  | 3           | 2          | 2          | 2         | 2                 | 250            | Yellow  | 250<br>(1)           | A29D<br>(1)                       | B29D<br>(1)                            | E29D<br>(1)                       | C29D<br>(1)                       | F29D<br>(1)                        | U29RT<br>(2)                            | 11/16<br>(5) | 11/16<br>(3)        | Yellow<br>(2)         | 60(1)<br>62(1)                            | 1-3/4"   |  |  |
| -300                          | 2/0-300   | 4  | 4           | 3          | 3          | 3         | 3                 | 300            | White   |                      | A30D<br>(2)                       | B30D<br>(2)                            | E30D<br>(2)                       | C30D<br>(2)                       | F30D<br>(2)                        | U30RT<br>(2)                            | 7/8<br>(5)   | 7/8<br>(3)          | *White<br>(4)         | 66H(4)<br>66(2)                           | 2-1/8"   |  |  |
| -350                          | 3/0-350   | 5  |             | 3          | 3          | 3         | 3                 | 350            | Red   |                      | A31D<br>(2)                       | B31D<br>(2)                            | E31D<br>(2)                       | C31D<br>(2)                       | F31D<br>(2)                        | U31RT<br>(2)                            | 8/40<br>(5)  | 8/40<br>(3)         | *Red<br>(4)           | 71H(4)<br>71(2)                           | 2-1/8"   |  |  |
| -400                          | 4/0-400   | 6  |             | 3          | 3          | 3         | 3                 | 400            | Blue  |                      | A32D<br>(2)                       | B32D<br>(2)                            | E32D<br>(2)                       | C32D<br>(2)                       | F32D<br>(2)                        | U32RT<br>(2)                            |              |                     | *Blue<br>(4)          | 76H(4)<br>76(2)                           | 2-1/4"   |  |  |
| -500                          | 4/0-500   | 6  |             | 4 O'lap    | 4 O'lap    | 4         | 4                 | 2 <sup>②</sup> | 500   | Brown                | A34D<br>(2)                       | No Die<br>Required<br>(2)              | E34D<br>(2)                       | C34D<br>(2)                       | F34D<br>(2)                        | U34RT<br>(4)                            |              | 1 or<br>1-2<br>(3)  | *Brown<br>(4)         | 87H(4)<br>87(2)                           | 2-3/8"   |  |  |
| -600                          | 250-600   |  |             |            | 4          |           | 4                 | 3 <sup>②</sup> | 600   | Green                |                                   |  | E36D<br>(2)                       | C36D<br>(2)                       | F36D<br>(2)                        | U36RT<br>(5)                            |              |                     |                       | 94H(4)<br>94(2)                           | 2-13/16" |  |  |
| -750                          | 500-750   |  |             |            | 4 O'lap    |           | 4                 | 3              | 750   | Black                |                                   |  | E39D<br>(2)                       | C39D<br>(2)                       | F39D<br>(2)                        |   |              |                     |                       | 106H(4)<br>106(2)                         | 3"       |  |  |
| -800                          | 500-800   |  |             |            |            |           |                   | 3              | 800   |                      |                                   |  | E40D<br>(2)                       | C40D<br>(2)                       | F40D<br>(2)                        |   |              |                     |                       | 107H(4)<br>107(2)                         | 3-1/16"  |  |  |
| -1000                         | 750-1000  |  |             |            |            |           | 4 O'lap           | 1000           |   |                      |                                   |  | No Die<br>Required<br>(2)         | C44D<br>(2)                       | F44D<br>(2)                        |   |              |                     |                       | 125H(4)<br>125(2)                         | 3-1/8"   |  |  |
| -1500                         | 1000-1500   |  |             |            |            |           | 4 O'lap           | 1500           |   |                      |                                   |  |                                   | C46D<br>(2)                       | F46D<br>(2)                        |   |              |                     |                       |   |          | 3-5/16"  |  |

\* TBM-8 Tool ONLY

<sup>†</sup> Burdny Y45 head requires an adapter for use with "U" series dies.

① Users of VC6 and VC7 tools must strip off an extra 1-5/8" of insulation from one end of cable to permit removal of tool over conductor sizes 250 MCM and larger on "VHS" sleeves.

② VC8 tool crimps 500 MCM ONLY.

③ VC8 tool crimps 500-600 MCM ONLY.

\* Not UL Listed-pending completion of test.

Catalog Home



[Warranty Info](#) | [Trademarks](#) | [Terms of Use](#)

All contents Copyright © 2007 Hubbell Power Systems, Inc. All rights reserved.

NOTE: Because Hubbell has a policy of continuous product improvement, we reserve the right to change design and specifications without notice.