

# Product End-of-Life Instructions

## 8501X Machine Tool Relays (DC)

### Product Range

8501X Machine Tool Relays (DC)

### Marketing Model

8501XDO●●●, 8501XUD●●●, 8501XDL●●●

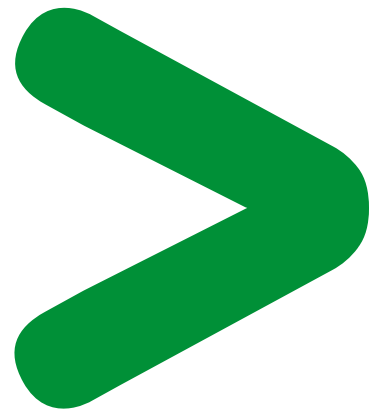
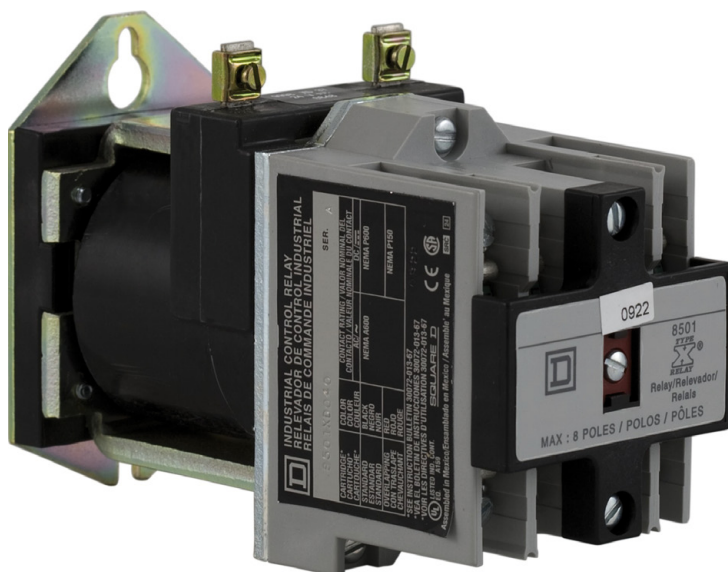

**Size in mm (H x L x D):**

90 x 57 x 131

**Weight in g :**

Between 1406 and 1823 without battery



**Schneider**  
Electric

## Operations recommended for the end of life treatment

There are several steps to process the products at the end of life so as to recover components, materials or energy :

Reuse ⇒ Separation for special treatment ⇒ Other Dismantling ⇒ Shredding

The components of the products that optimize the recycling performances are listed, identified and located hereunder.

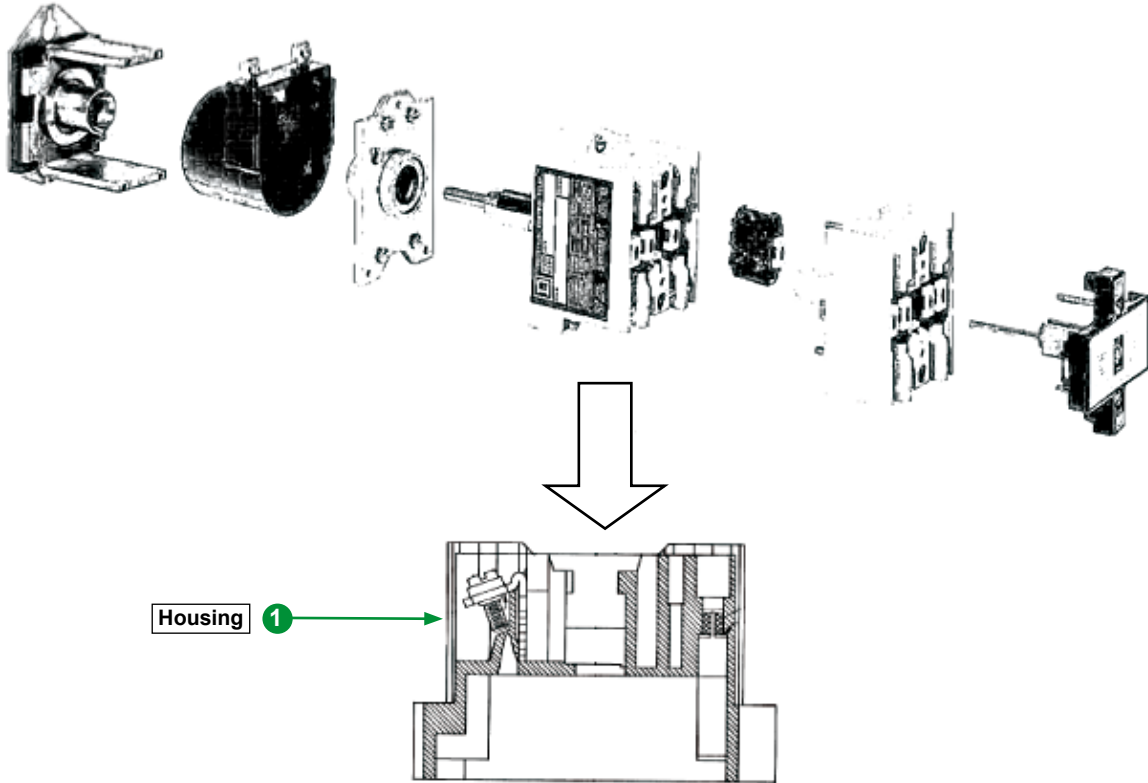

Recommendation	Number on drawing	Components	Weight (g)	Comment
Special treatment	1	Housing	28	1 Plastic part > PBT +PC + GF30 FR <

### Schneider Electric Industries SAS

35, rue Joseph Monier  
CS30323  
F - 92506 Rueil Malmaison Cedex

RCS Nanterre 954 503 439  
Capital social 896 313 776 €  
www.schneider-electric.com

The version of the Guide used to create the document: End of Life Instruction Drafting Guide of Schneider Electric version V1.

Publication : Schneider Electric