

Hospital Products

Hubbellock® Plugs, Connector Bodies and Receptacles

For Hospital Use Only



Hubbellock® Plugs and Connector Bodies

Description	Plugs	Connector Bodies
Nylon cover, thermoset interior.	HBL23014HGB	HBL23001HGB
Armored, epoxy filled, rubber cord grip.	HBL23004HG	—

Note: Cord clamp range for plug and connector .300" to .660" (7.6 to 16.8).



20A 125V AC



20A 125V AC

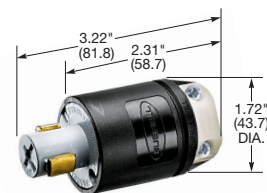

HBL23014HGB



HBL23001HGB

Receptacles

Description	Catalog Number
Black, back wired.	— HBL23000HG

Wallplates

Description	Catalog Number
Stainless steel 302/304, single-gang.	HBL23901HG
Stainless steel 302/304, three-gang for two receptacles.	HBL23909HG

Note: Suffix HG or HGB type for hospital use only.



IP30
SUITABILITY

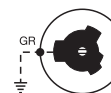

20A 125V AC

Explosion Proof Plug

Description	Catalog Number
Plug, with, epoxy kit, accepts #12 or #14 type SO cable.	HBL24312

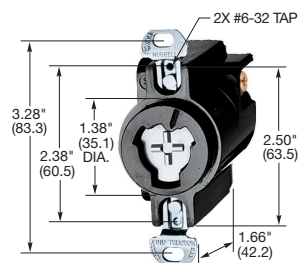

HBL23000HG

Hazardous to Non-hazardous Location Receptacle Conversion Kits

Conversion kits for replacement of explosion proof receptacles listed above, with non-explosion proof receptacles, in the hospital areas formerly classified as hazardous locations and now classified non-hazardous locations due to the change from flammable anesthetizing gases to nonflammable anesthetizing gases.

For Conversion To:	Catalog Number
20A, 125V, duplex receptacle (Hubbell HBL830 Series). Includes adapter ring and stainless steel wall plate for duplex receptacle (receptacle not included).	HBL24300RKD
20A, 125V, Hospital Hubbellock receptacle (Hubbell HBL23000HG) or 20A, 125V, straight blade single receptacle (Hubbell HBL8310 series). Includes adapter ring and stainless wall plate for single receptacle (receptacle not included).	HBL24300RKS

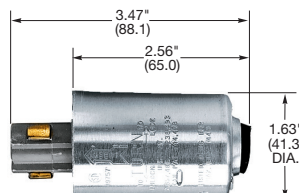

HBL24312

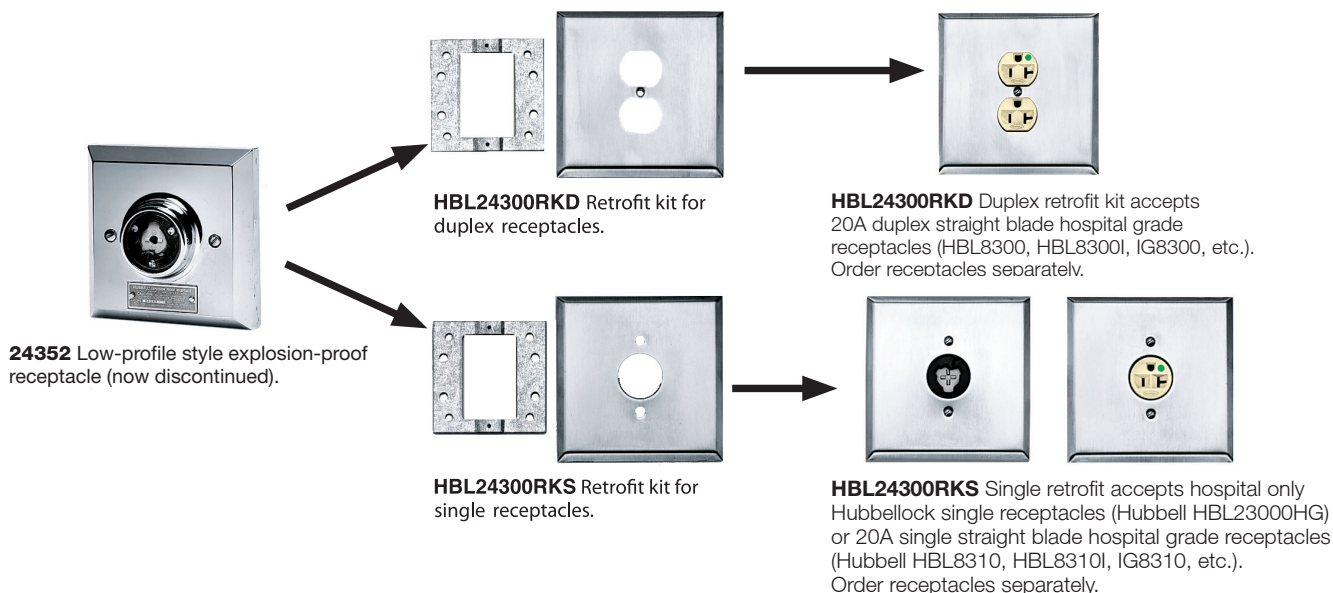

Dimensions in Inches (mm)