

Motor Pigtail Connectors

Motor Pigtail Connector — One Line to Two Load (3 Wire)

- KON-TOUR™ louvered contact bands
- Color coded to match installing dies

Material: High-Conductivity Wrought Copper

Finish: Electro-Tin Plate

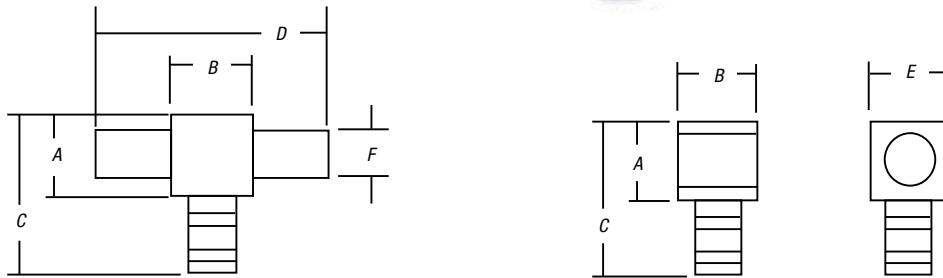

CAT. NO.		WIRE SIZE	BODY SIZE	COLOR CODE	BOOT INSULATION	DIMENSIONS (IN.)						STRIP LENGTH (IN.)
FEMALE DISCONNECT	MALE DISCONNECT					A	B	C	D	E	F	
MD1614F-0	M2D1614M-0	#16-#14 AWG	0	BLUE	MDBOOT-1	.250	.250	.63	.77	.25	.12	3/8
MD1210F-1	M2D1210M-1	#12-#10 AWG	1	YELLOW	M2DBOOT-1	.380	.380	.780	.750	.380	.25	3/8
MD1210F-2	M2D1210M-2	#12-#10 AWG	2	YELLOW	M2DBOOT-2	.500	.500	.900	1.500	.500	.37	3/8
MD8F-1	M2D8M-1	#8 AWG	1	RED	M2DBOOT-1	.380	.380	.820	1.125	.380	.25	7/16
MD8F-2	M2D8M-2	#8 AWG	2	RED	M2DBOOT-2	.500	.500	.950	1.500	.500	.37	7/16
MD6F-1	M2D6M-1	#6 AWG	1	BLUE	M2DBOOT-1	.380	.380	.875	1.125	.380	.25	1/2
MD6F-2	M2D6M-2	#6 AWG	2	BLUE	M2DBOOT-2	.500	.500	1.020	1.500	.500	.37	1/2
MD4F-2	M2D4M-2	#4 AWG	2	GRAY	M2DBOOT-2	.500	.500	1.060	1.500	.500	.37	1/2
MD2F-2	M2D2M-2	#2 AWG	2	BROWN	M2DBOOT-2	.500	.500	1.090	1.500	.500	.37	17/32
MD2F-3	M2D2M-3	#2 AWG	3	BROWN	M2DBOOT-3	.875	.875	1.460	2.630	.875	.50	17/32
MD1F-2	M2D1M-2	#1 AWG	2	GREEN	M2DBOOT-2	.50	.50	1.230	1.500	.500	.37	9/16
MD1F-3	M2D1M-3	#1 AWG	3	GREEN	M2DBOOT-3	.875	.875	1.560	2.630	.875	.50	9/16
MD10F-3	M2D10M-3	1/0 AWG	3	PINK	M2DBOOT-3	.875	.875	1.560	2.630	.875	.50	9/16
MD20F-3	M2D20M-3	2/0 AWG	3	BLACK	M2DBOOT-3	.875	.875	1.590	2.630	.875	.50	5/8
MD30F-3	M2D30M-3	3/0 AWG	3	ORANGE	M2DBOOT-3	.875	.875	1.710	2.630	.875	.50	11/16
MD40F-3	M2D40M-3	4/0 AWG	3	PURPLE	M2DBOOT-3	.875	.875	1.810	2.630	.875	.50	3/4

Operating Range: 600V max., 1000V max. in signs and fixtures.

Listing: UL® Listed and CSA Certified for #12-#8 AWG solid copper conductors and stranded copper conductors in the sizes shown.

Selection: Always use the same body size when selecting male and female disconnects. For example, to connect a #2 AWG male to a #8 AWG female, select Catalog Numbers M2D2M-2 and MD8F-2. Both have body size 2.

Insulation: Use insulating boots matching the disconnect body size as indicated in the chart. To protect the connection from moisture and dirt, use sealing compound (Catalog Number MDBOOT-SEAL).

Tooling: pp. F-80-F-100

Die Selector Chart: pp. F-101-F-104

Motor Pigtail Connectors

Motor Pigtail Connector — One Line to Two Load (3 Wire) (continued)

- KON-TOUR™ louvered contact bands
- Color coded to match installing dies

Material: High-Conductivity Wrought Copper

Finish: Electro-Tin Plate

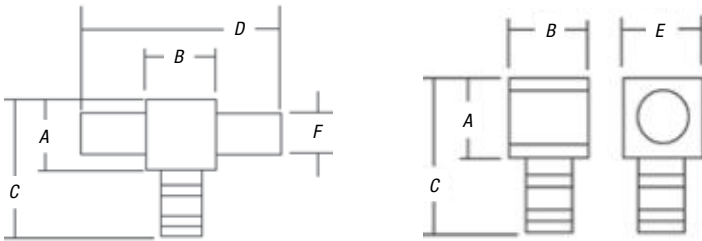

INSTALLING TOOLS

CAT.NO.	FEMALE DISCONNECT	MALE DISCONNECT	WT112M WT111M ERG4002 WT2000	TBM6 TBM6S				TBM5 TBM5S	TBM8 TBM8S	HYDRAULIC TOOLS	
				TBM25S	UPPER DIE	LOWER DIE	DIE SET	DIE SET	DIE CODE	COLOR	
MD1614F-0	M2D1614M-0		BLUE	—	—	—	—	—	—	—	—
MD1210F-1	M2D1210M-1		BLUE	—	—	—	—	—	—	—	—
MD1210F-2	M2D1210M-2		YELLOW	—	—	—	—	—	—	—	—
MD8F-1	M2D8M-1		YELLOW	X	13475	13477	13454	13461	21	RED	RED
MD8F-2	M2D8M-2		—	X	13475	13477	13454	13461	21	RED	RED
MD6F-1	M2D6M-1		—	X	13475	13477	13454	13461	24	BLUE	BLUE
MD6F-2	M2D6M-2		—	X	13475	13477	13454	13461	24	BLUE	BLUE
MD4F-2	M2D4M-2		—	X	13472	13476	13454	13461	29	GRAY	GRAY
MD2F-2	M2D2M-2		—	X	13474	13477	13454	13461	33	BROWN	BROWN
MD2F-3	M2D2M-3		—	X	13474	13477	13454	13461	33	BROWN	BROWN
MD1F-2	M2D1M-2		—	—	13474	13477	13455	13462	37	GREEN	GREEN
MD1F-3	M2D1M-3		—	—	13474	13477	13455	13462	37	GREEN	GREEN
MD10F-3	M2D10M-3		—	—	13475	13477	13455	13462	42	PINK	PINK
MD20F-3	M2D20M-3		—	—	13474	13477	13455	13462	45	PINK	PINK
MD30F-3	M2D30M-3		—	—	13474	13477	13455	13462	50	ORANGE	ORANGE
MD40F-3	M2D40M-3		—	—	13475	13477	13456	13463	54	PURPLE	PURPLE

Tooling: pp. F-80-F-100

Die Selector Chart: pp. F-101-F-104