

| CODE (1) | SEE NOTE | TYPE | SOLD IN LOTS OF | VOLTAGE RANGE |
|----------|----------|---------------|-----------------|---------------------------|
| E1B | (2) | VARISTOR | 5 | 12 TO 24V a.c. AND d.c. |
| E1E | (2) | VARISTOR | 5 | 32 TO 48V a.c. AND d.c. |
| E1U | (2) | VARISTOR | 5 | 50 TO 129V a.c. AND d.c. |
| E1UG | (2) | VARISTOR | 5 | 130 TO 250V a.c. AND d.c. |
| C1B | (3) | DIODE + ZENER | 5 | 12 TO 24 Vdc |
| C1E | (3) | DIODE + ZENER | 5 | 32 TO 48 Vdc |
| A1U | (4) | RC | 5 | 220 TO 250 Vac |

- (2) Protection by limitation of the transient voltage to 2 Uc maximum. Maximum reduction of the transient voltage peaks. Slight time delay on drop-out (1.1 to 1.5 times normal).
- (3) No overvoltage or oscillation frequency. Polarized component. Slight time delay on drop-out (1.1 to 1.5 times normal).
- (4) Protection by limitation of the transient voltage to 3 Uc maximum and limitation of the oscillation frequency. Slight time delay on drop-out (1.2 times normal).

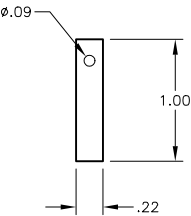

Direct mounting on the mini-contactor

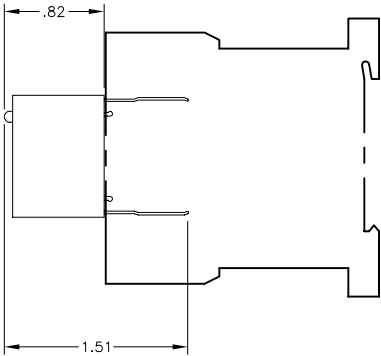

Catalog Number: LA4 K(1)
Ratings: SEE CHART
UL File/Guide: —
CSA File/Guide: —
Meets Standards: —
Weight: —
Wire Size: SEE CHART
Terminal torque: —
Mounting Hwd.: CLIP-ON FRONT MOUNTING

"THE SQUARE D COMPANY HAS PROPRIETARY RIGHTS TO THE INFORMATION CONTAINED HEREON. THIS INFORMATION REMAINS THE PROPERTY OF SQUARE D COMPANY AND MAY BE USED ONLY IN CONFORMANCE WITH INSTRUCTIONS ISSUED BY SQUARE D COMPANY. USER SHOULD VERIFY DRAWINGS ARE TO THE LATEST/CURRENT REVISION PRIOR TO INCORPORATING IN A DESIGN FILE."

DO NOT SCALE DRAWING
UNLESS OTHERWISE SPECIFIED DIMENSIONS ARE IN INCHES

THIRD ANGLE PROJECTION
TOLERANCES
UNLESS OTHERWISE SPECIFIED
2 PLACE DECIMALS ± .01

IEC SUPPRESSOR MODULE
W/LED INDICATOR (K-LINE)
LA4 K(1)

 **SQUARE D COMPANY**

DWG# E0211201-01
NO.