



**Product Datasheet**

**ANDERSON FARGO**

**VHCS4012 -- Terminal, Compression**



Copper Compression Terminal lug (Short Barrel)

**Product Specifications**

<p>Series Image (Lugs)</p>	 <p><b>VHCS Series</b> Copper Compression Lug Standard Barrel 1 or 2 hole Tin Plated - UL Listed VERSAtile (die and VC tools)</p>
<b>Material</b>	Copper
<b>PDF Catalog Page</b>	<a href="#">Click HERE to view the web page.</a>
<b>Plating</b>	Yes
<b>Inhibitor</b>	No
<b>Number of Pad Holes</b>	1
<b>Pad Bolt Diameter</b>	0.50 in (12.7 mm)
<b>VersaCrimp Conductor Size Minimum</b>	.328 in
<b>VersaCrimp Conductor Size Maximum</b>	.528 in
<b>Die Type Tooling Crimp Conductor Size Minimum</b>	.522 in
<b>Die Type Tooling Conductor Size Maximum</b>	.528 in
<b>Lug Conductor Type</b>	CU
<b>Spade Holes</b>	1
<b>Bolt Diameter</b>	0.50 in (12.70 mm)
<b>Crimp Method</b>	VERSAtile (accommodates conventional and Anderson tools)
<b>UL Listed</b>	Yes
<b>Body Material</b>	Copper Tube
<b>Dimension B</b>	1 in (25.4 mm)
<b>Dimension L</b>	2.875 in (73.02 mm)
<b>Dimension T</b>	0.125 in (3.18 mm)
<b>Dimension W</b>	1 in (25.4 mm)
<b>UPC Code</b>	09635933865
<b>Standard Package</b>	10
<b>Standard Package Unit</b>	Each
<b>Min Order Qty</b>	10
<b>Weight / Ea.</b>	0.098 lbs

Material Type

Non-Standard

### Notes

For use with either VERSA-Crimp or conventional compression tools. For use with copper stranded conductor only. When used with die type compression tools, use with maximum size conductor only Rated at 34.5 KV.

### Features

Color coded bands or easy die selection.

### Compressed Product Number

VHCS4012

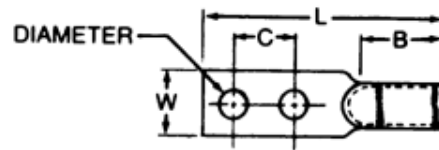
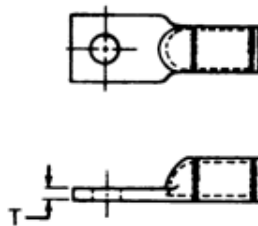

## VHSS & VHCS

Catalog Number VHSS VHCS	ANDERSON™ VERSA-CRIMP® COMPRESSION TOOLS (Crimps per Connection)								CONVENTIONAL COMPRESSION DIE TOOLING (Crimps per Connection)											Conductor Insulation Strip Lengths (Min.) ⊖			
	V-C Tools Wire Range AWG or MCM Stranded (Copper Only)	VERSA-CRIMP® Tools (Number of Crimps)							Copper Wire Size AWG or MCM STR	Die Color Code	Burdny (Crimps)	Burdny Longitudinal Indent (Crimps)						Kearney (Crimps)			Thomas & Betts (Crimps)		
		VC5 -500	VC6 -350	VC6 ⊖	VC6 FT	VC7	VC7 FT	VC8 AL NIBS				Tool MY29-3	Tool Y34A Indentor Y34PR	Tool Y34B Indentor Y34PR	Tool Y44B Indentor Y44PR	Tool Y44B Indentor Y48PR	Tool Y46RB Indentor Y48PR	Tools Y35 Y39 Y45†	Tools "O"		Tools "WH"	Tools TBM5 TBM8	Hyd. Tools 12, 15 20 & 40 Ton
-6	#6	1	1					#6	Blue	#6 (1)	A6CD (1)	B6CD (1)				U5CRT (1)			Blue (2)	24 (1)	15/16"		
-4	#4	1	1					#4	Gray	#4 (1)	A4CD (1)	B4CD (1)				U4CRT (1)	5/16 (3)	5/16 (1)	Gray (2)	29 (1)	15/16"		
-2	#6-#2	1	1	1	1	1	1	#2	Brown	#2 (1)	A2CD (1)	B2CD (1)				U2CRT (1)	3/8 (3)	3/8 (1)	Brown (2)	33 (1)	1"		
-1	#6-#1	1	1	1	1	1	1	#1	Green	#1 (1)	A1CD (1)	B1CD (1)				U1CRT (1)			Green (2)	37 (1)	1"		
-1/0	#6-1/0	1	1	1	1	1	1	1/0	Pink	1/0 (1)	A25D (1)	B25D (1)	E25D (1)			U25RT (1)	1/2 (2)	1/2 (1)	Pink (2)	42H(2) 42(1)	1"		
-2/0	#4-2/0	1	1	1	1	1	1	2/0	Black	2/0 (1)	A26D (1)	B26D (1)	E26D (1)			U26RT (1)	9/16 (3)	9/16 (1)	Black (2)	45 (1)	1-1/16"		
-3/0	#2-3/0	2	2	2 O/lap	2 O/lap	2	2	3/0	Orange	3/0 (1)	A27D (1)	B27D (1)	E27D (1)			U27RT (1)	9/16 (3)	9/16 (2)	Orange (2)	50 (1)	1-1/8"		
-4/0	#1-4/0	2	2	2 O/lap	2 O/lap	2	2	4/0	Purple	4/0 (1)	A28D (1)	B28D (1)	E28D (1)	C28D (1)	F28D (1)	U28RT (1)	5/8-1 (3)	5/8-1 (2)	Purple (2)	54 (1)	1-1/8"		
-250	1/0-250	2	2	2 O/lap	2 O/lap	2	2	250	Yellow	250 (1)	A29D (1)	B29D (1)	E29D (1)	C29D (1)	F29D (1)	U29RT (1)	11/16 (3)	11/16 (2)	Yellow (2)	60(1) 62(1)	1-3/16"		
-300	2/0-300	2	2	2 O/lap	2 O/lap	2	2	300	White		A30D (1)	B30D (1)	E30D (1)	C30D (1)	F30D (1)	U30RT (1)	7/8 (3)	7/8 (2)	*White (2)	66H(2) 66(1)	1-3/16"		
-350	3/0-350	3 O/lap		2 O/lap	2 O/lap	2	2	350	Red		A31D (1)	B31D (1)	E31D (1)	C31D (1)	F31D (1)	U31RT (1)	8/0 (3)	8/0 (2)	*Red (2)	71H(2) 71(1)	1-1/4"		
-400	4/0-400	3 O/lap		2 O/lap	2 O/lap	2	2	400	Blue		A32D (1)	B32D (2)	E32D (1)	C32D (1)	F32D (1)	U32RT (1)			*Blue (2)	76H(2) 76(1)	1-5/16"		
-500	4/0-500	4 O/lap		2	2	2	2	500	Brown		A34D (1)	No Die Required (1)	E34D (1)	C34D (1)	F34D (1)	U34RT (2)		1 or 1-2 (2 O/lap)	*Brown (2)	87H(2) 87(1)	1-1/2"		
-600	250-600				2		2	600	Green				E36D (1)	C36D (1)	F36D (1)	U36RT (2)				94H(2) 94(1)	1-1/2"		
-750	500-750				3 O/lap		3	750	Black				E39D (1)	C39D (1)	F39D (1)					106H(2) 106(1)	1-3/4"		
-800	500-800						2 O/lap	800					E40D (1)	C40D (1)	F40D (1)					107H(2) 107(1)	1-3/4"		
-1000	750-1000						2	1000					No Die Required (1)	C44D (1)	F44D (1)					125H(2) 125(1)	2"		
-1500	1000-1500						2	1500						C46D (1)	F46D (1)							2-1/8"	

\* TBM-8 ONLY

† Burdny Y45 head requires an adapter for use with "U" series dies.

⊖ Users of VC6 and VC7 tools must strip off an extra 1-5/8" of insulation from one end of cable to permit removal of tool over conductor sizes 250 MCM and larger on "VHSS" sleeves.

⊖ VC8 tool crimps 500 MCM ONLY.

⊖ VC8 tool crimps 500-600 MCM ONLY.

\* Not UL Listed-pending completion of test.

Catalog Home



[Warranty Info](#) | [Trademarks](#) | [Terms of Use](#)

All contents Copyright © 2007 Hubbell Power Systems, Inc. All rights reserved.

NOTE: Because Hubbell has a policy of continuous product improvement, we reserve the right to change design and specifications without notice.