

2-POLE DEFINITE PURPOSE - 600 VAC, 50-60 HZ

FULL LOAD AMPERES	
TYPE	FLA
12	20 FLA
22	25 FLA
32	30 FLA
42	40 FLA

COIL VOLTAGE CODE (1)	VOLTAGE	50 HZ
V14	24	24
V02	120	110
V09	208-240	220
V04	277	-
V06	480	440
V07	600	550

QUICK CONNECT TERMINALS AND BINDER HEAD SCREWS FOR EASY WIRING.

* = BOX LUGS #14-#4 AWG WIRE SIZE

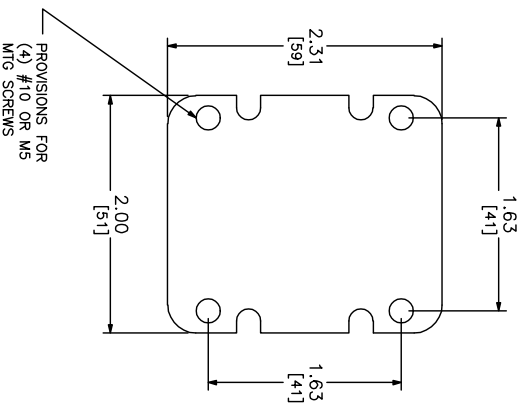
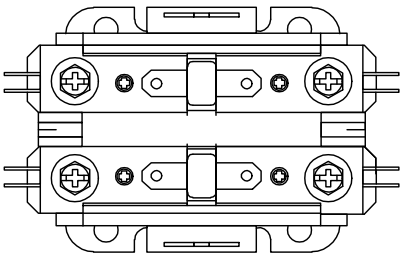
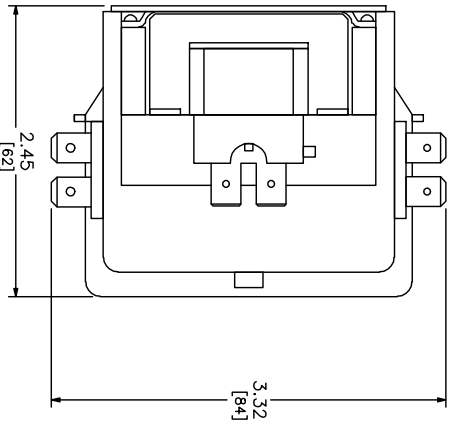

CATALOG NUMBER: 8910-DP(2)(1)
 RATINGS: SEE CHART
 UL FILE/CN: UL E78351/MLDX2
 CSA FILE/CLASS: CSA 172334/321104
 MEETS STANDARDS: -
 WEIGHT: 0.58 LB
 WIRE SIZE: #16-8 AWG
 TERMINAL TORQUE: 22LB - IN (20 TO 30 FLA) 40LB - IN (40 FLA)
 MOUNTING HWD.: (4) #10 OR M5 SCREWS

DUAL DIMENSIONS: INCHES
 MILLIMETERS

DEFINITE PURPOSE CONTACTOR (2 POLE)
 CLASS 8910 TYPE DP (2) (1)
 SERIES C

 **Schneider Electric**
 DWG# E0310101-01-C