



Product Datasheet

ANDERSON FARGO

YCS2090 -- Y-Clevis Eye



Y-Clevis Eye, Rotated, Ductile Iron, 0.750" Curved Bolt, Eye: 2.000" with 0.688" Hole, UTS 30,000 lb

Product Specifications

Hardware Family



**Clevis Eye &
Y-Clevis Eye**
Coupling Fittings

Clevis Eye Fittings

YCS1090
Photo Sample

YCS-90 Series
Y-Clevis Eye, Rotated
Coupling Fittings

PDF Catalog Page

[Click HERE to view the web page.](#)

Ultimate Strength

30,000 lb (13,608 kg)

Coupling Length

2.438 in (61.91 mm)

Eye Width

2.000 in (50.80 mm)

Eye Hole Diameter

0.688 in (17.48 mm)

Dimension B

1.625 in (41.28 mm)

Dimension R

0.813 in (20.64 mm)

Dimension W

2.00 in (50.80 mm)

Dimension PD

0.750 in (19.05 mm)

Material

Ductile Iron

Cotter Pin Material	Stainless Steel
Clevis Pin Material	Galvanized Steel
Material Type	Non-Standard
UPC Code	09635934469
Standard Package	20
Standard Package Unit	Each
Min Order Qty	1
Weight / Ea.	2.323 lbs

Compressed Product Number

YCS2090

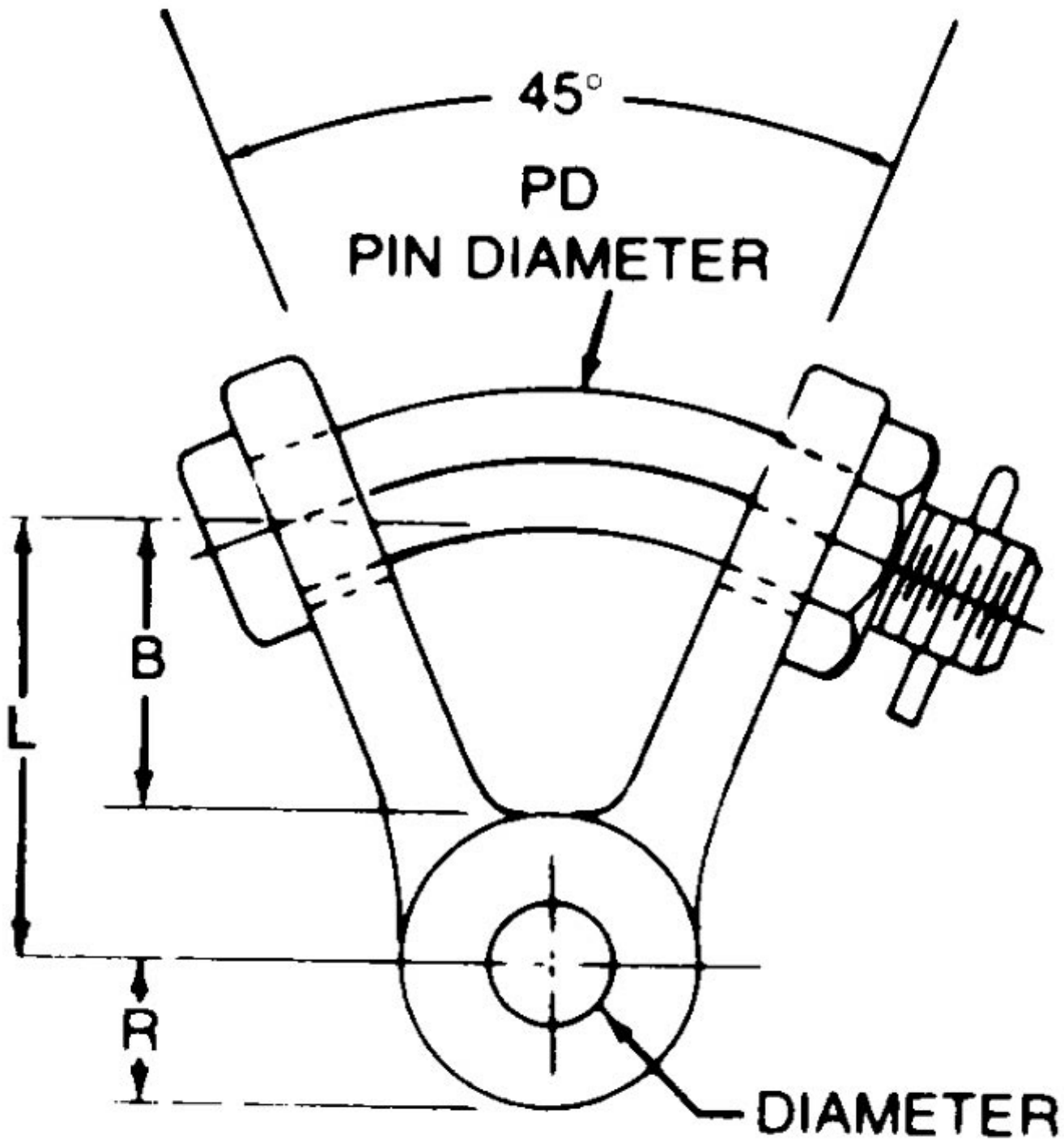

FIGURE 2 YCS-90

[Catalog Home](#)



[Warranty Info](#) | [Trademarks](#) | [Terms of Use](#)

All contents Copyright © 2007 Hubbell Power Systems, Inc. All rights reserved.

NOTE: Because Hubbell has a policy of continuous product improvement, we reserve the right to change design and specifications without notice.